

# Area 7

## SE MN Association of Conservation Districts Directory

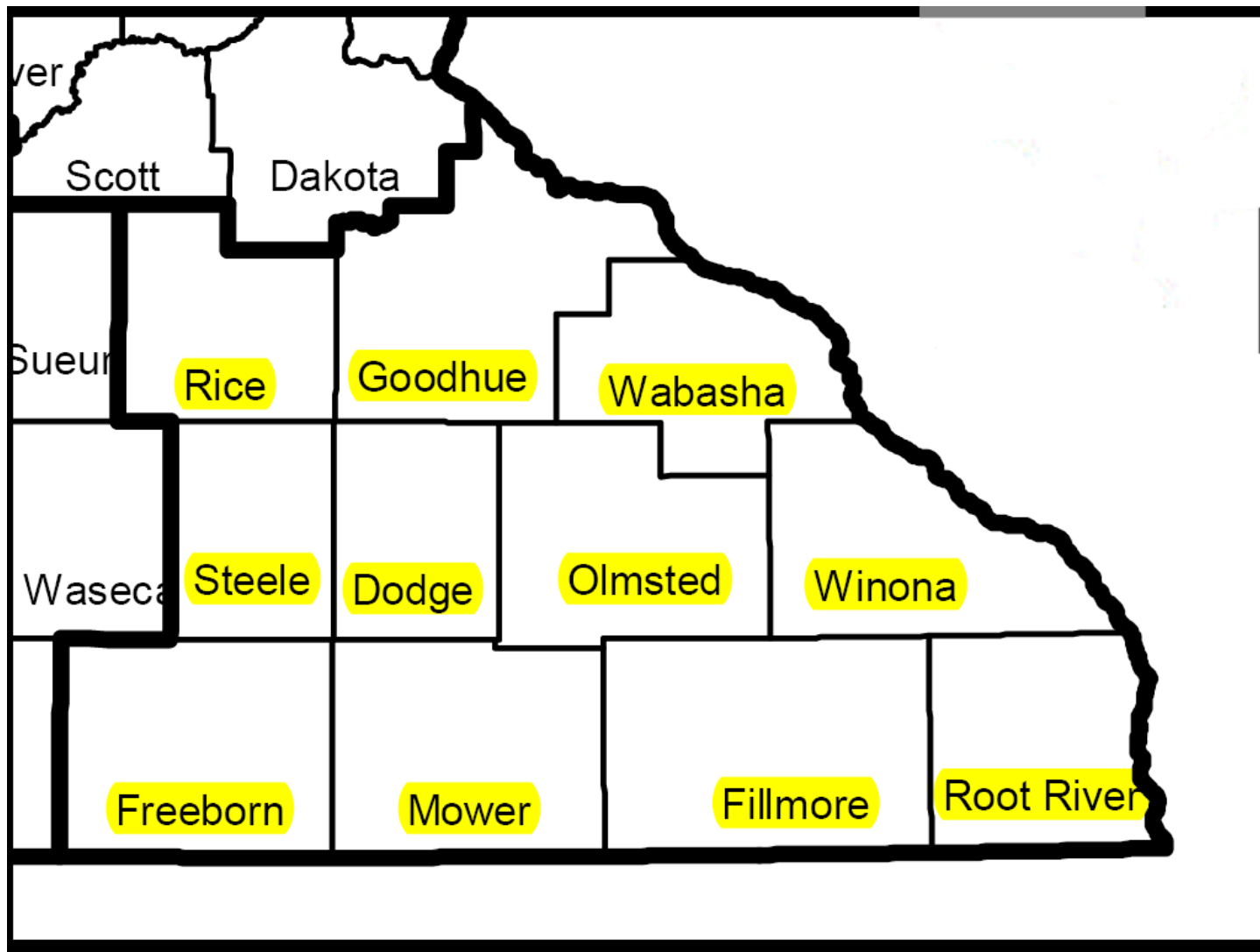

Revised March 13, 2012

**Dodge SWCD** –916 2<sup>nd</sup> St. SE, Dodge Center, MN 55927  
 507 374-6364 Ext 3 Fax # 507-374-6333 <http://www.dodgeswcd.org>

**Staff:**

James Hruska District Technician [jim.hruska@mn.nacdnet.net](mailto:jim.hruska@mn.nacdnet.net)  
 Tom Johnston District Technician [tom.johnston@mn.nacdnet.net](mailto:tom.johnston@mn.nacdnet.net)  
 Blaine Delzer Feedlot Technician [blaine.delzer@mn.nacdnet.net](mailto:blaine.delzer@mn.nacdnet.net)

Meeting: 3<sup>rd</sup> Thursday of the Month at 7:15pm April –Nov. and 1:15pm Dec.-March

**Board Members:**

Darrel Faulkner	507-527-2537	<a href="mailto:faulkners@frontiernet.net">faulkners@frontiernet.net</a>	18339 Co. Highway 24, West Concord, MN 55985
Muriel French	507-635-5619	<a href="mailto:dcfrench@kmtel.com">dcfrench@kmtel.com</a>	56330 State Highway 57, Dodge Center, MN 55927
Dave Livingston	507-374-6876	<a href="mailto:sportyacres_del@yahoo.com">sportyacres_del@yahoo.com</a>	67432 State Highway 56, Dodge Center, MN 55927
Glenn Hahn	507-365-8608	<a href="mailto:ghahn@kmtel.com">ghahn@kmtel.com</a>	24402 Dodge-Mower Road, Sargeant, MN 55973
Larry Scherger	507-374-2170	<a href="mailto:lscherg@myway.com">lscherg@myway.com</a>	63209 165th Avenue, Dodge Center, MN 55927

**NRCS Staff:** 507-374-6364

Brian DeVetter	District Con	<a href="mailto:brian.devetter@mn.usda.gov">brian.devetter@mn.usda.gov</a>
Jeffrey King	Water Quality Spec.	<a href="mailto:jeff.king@mn.usda.gov">jeff.king@mn.usda.gov</a>
Donna Marie Klapperich	Soil Conservation Tech	<a href="mailto:donna.klapperich@mn.usda.gov">donna.klapperich@mn.usda.gov</a>

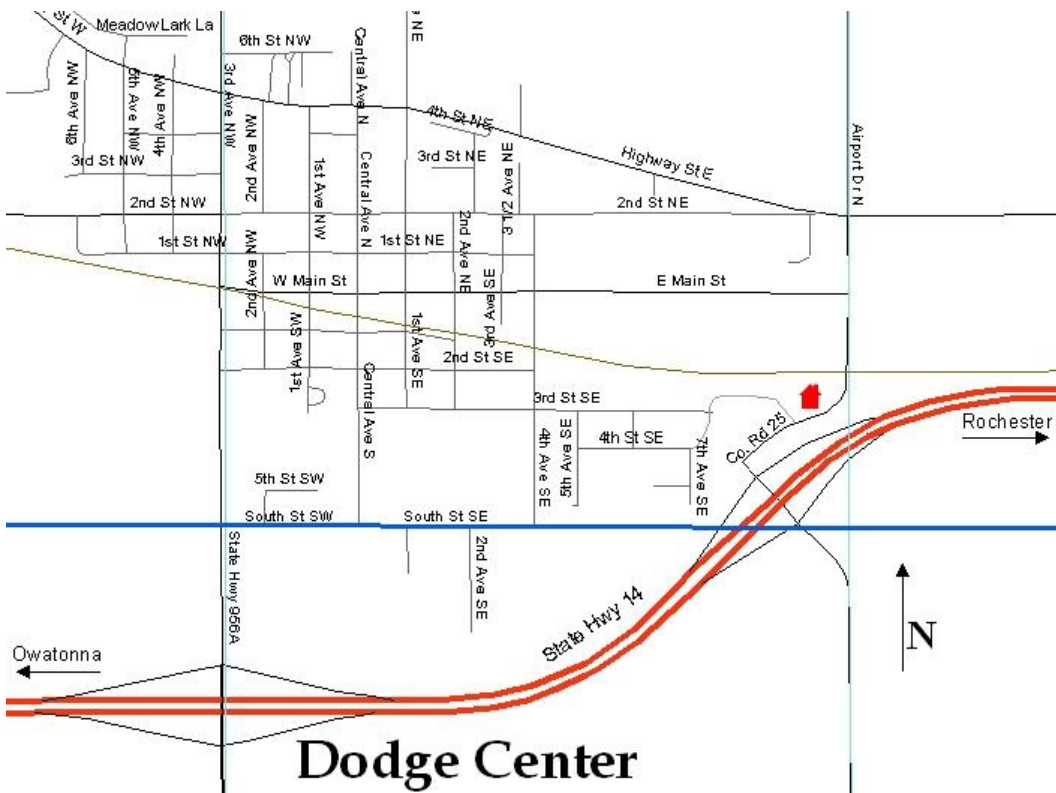

\*\*Emergency contact:  
 Jim Hruska (home) 507-633-2648 (cell) 507-421-5962

**Fillmore SWCD** – 900 Washington St NW, Preston, MN 55965  
 507-765-3878 FAX 507-765-4415 [www.fillmoreswcd.org](http://www.fillmoreswcd.org)

**Staff:**

Donna Rasmussen	District Administrator	<a href="mailto:donna.rasmussen@fillmoreswcd.org">donna.rasmussen@fillmoreswcd.org</a>
Rick Grooters	Resource Con. Tech	<a href="mailto:rick.grooters@fillmoreswcd.org">rick.grooters@fillmoreswcd.org</a>
Doug Keene	Resource Con. Tech	<a href="mailto:doug.keene@fillmoreswcd.org">doug.keene@fillmoreswcd.org</a>
Joe Magee	TMDL/Water Plan Coordinator	<a href="mailto:joe.magee@fillmoreswcd.org">joe.magee@fillmoreswcd.org</a>
Jeanette Serfling	Administrative Assistant	<a href="mailto:jeanette.serfling@fillmoreswcd.org">jeanette.serfling@fillmoreswcd.org</a>
Anne Koliha	Engineering Technician	<a href="mailto:anne.koliha@fillmoreswcd.org">anne.koliha@fillmoreswcd.org</a>
Dawn Bernau	Nutrient Mgmt Specialist	<a href="mailto:dawn.bernau@fillmoreswcd.org">dawn.bernau@fillmoreswcd.org</a>
Dean Thomas	Grazing Mgmt Specialist	<a href="mailto:dean.thomas@fillmoreswcd.org">dean.thomas@fillmoreswcd.org</a>
Jennifer Ronnenberg	Conservation Technician	<a href="mailto:jennifer.ronnenberg@fillmoreswcd.org">jennifer.ronnenberg@fillmoreswcd.org</a>
Ryan Thesing	Conservation Planning Specialist	<a href="mailto:ryan.thesing@fillmoreswcd.org">ryan.thesing@fillmoreswcd.org</a>

Meeting: Thursday after the second Monday of the Month at 4:30 PM at Fillmore SWCD Office, 900 Washington St. NW, Preston, MN.

**Board Members:**

Timothy Gossman	507-867-3129	<a href="mailto:tgossman@northlc.com">tgossman@northlc.com</a>	31924 Ninebark Rd, Chatfield, MN 55923
Brian Hazel	507-467-3470	<a href="mailto:hazbroy@acegroup.cc">hazbroy@acegroup.cc</a>	27919 State Hwy 250, Lanesboro, MN 55949
Pamela Mensink	507-765-3384	<a href="mailto:pamkmensink@gmail.com">pamkmensink@gmail.com</a>	23852 County 14, Preston, MN 55965
Leonard Leutink, Jr.	507-273-3855	<a href="mailto:lenleutink@gmail.com">lenleutink@gmail.com</a>	617 North Broadway, Lot #3, Spring Valley, MN 55975
Travis Willford	507-886-6891	<a href="mailto:tjwillford@hotmail.com">tjwillford@hotmail.com</a>	33568 County 30, Harmony, MN 55939

**NRCS Staff:** 507-765-3879

Robert Joachim	District Cons.	<a href="mailto:robert.joachim@mn.usda.gov">robert.joachim@mn.usda.gov</a>
Angela White	Soil Con Tech	<a href="mailto:angela.white@mn.usda.gov">angela.white@mn.usda.gov</a>
Jackie Byam	CSP Soil Con	<a href="mailto:jackie.byam@mn.usda.gov">jackie.byam@mn.usda.gov</a>

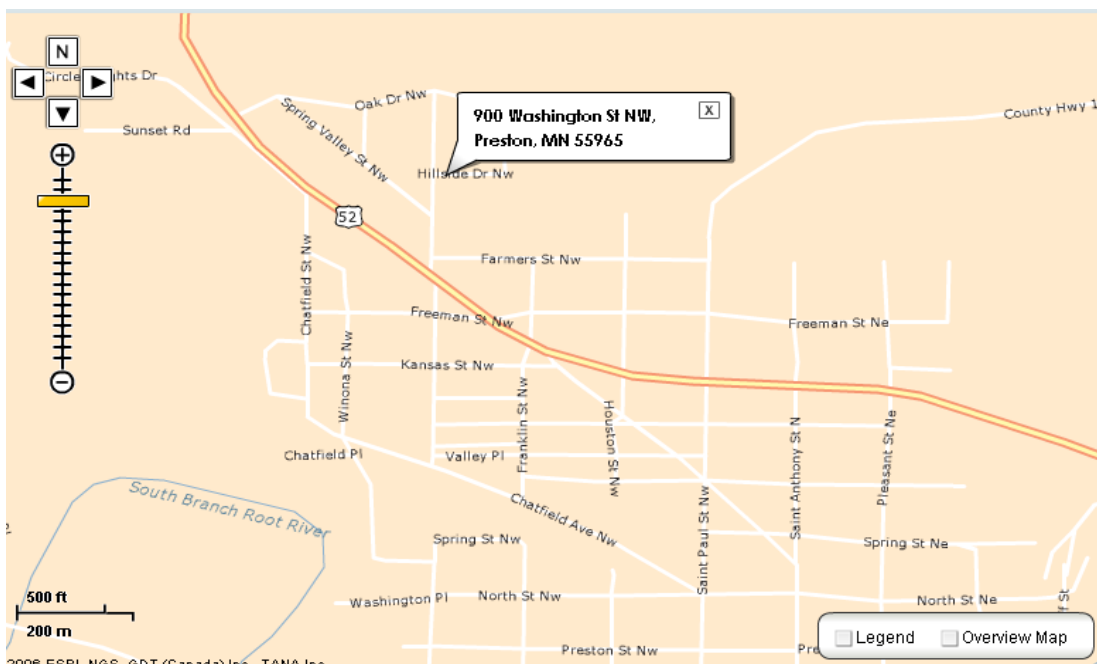

2006 ESRI, NGS, GDT (Canada) Inc., TANA Inc.  
 \*\*Emergency Contact: Rick Grooters 507-765-5379

**Freeborn SWCD** – 1400 W Main St, Albert Lea, MN 56007-1816  
507-373-5607, Ext. 3      FAX 507-373-7654      <http://www.freebornswcd.org>

**Staff:**

Mark Schaetzke	District Manager	<a href="mailto:mark.schaetzke@mn.nacdnet.net">mark.schaetzke@mn.nacdnet.net</a>
Brenda Lageson	Administrative Assistant	<a href="mailto:brenda.lageson@mn.nacdnet.net">brenda.lageson@mn.nacdnet.net</a>
Dustin Demmer (starts 3/12/2012)	District Tech	<a href="mailto:dustin.demmer@mn.nacdnet.net">dustin.demmer@mn.nacdnet.net</a>

**Meeting:**      **2<sup>nd</sup> Thursday of Month at Main Office**  
7:30 p.m. April – Nov.  
1:30 p.m. Dec. – March

**Board Members:**

Donald Kropp – Chairman	507-373-1925	<a href="mailto:donkropp@charter.net">donkropp@charter.net</a>	2005 Tower Rd., Albert Lea MN 56007
Chris Dahl – Vice-Chair	507-826-3463	<a href="mailto:chdahl@myclearwave.net">chdahl@myclearwave.net</a>	27296 730 <sup>th</sup> Av., Albert Lea MN 56007
David Ausen – Treasurer	507-863-2165	<a href="mailto:davaus@bevcomm.net">davaus@bevcomm.net</a>	69128 260 <sup>th</sup> St., Alden, MN 56009
Paul Heers, Jr. Secretary	507-437-2597	(None)	19917 890 <sup>th</sup> Ave, Oakland, MN 56007
Colin Wittmer, Supervisor	507-402-6562	<a href="mailto:colin.wittmer@county.freeborn.mn.us">colin.wittmer@county.freeborn.mn.us</a>	65361 140 <sup>th</sup> St, Alden, MN 56009

**NRCS Staff:**

**507-373-5607 Ext. 3**

Ed Moffett	District Conservationist	<a href="mailto:edward.moffett@mn.usda.gov">edward.moffett@mn.usda.gov</a>
Brian Jensen	Soil Con Tech	<a href="mailto:brian.jensen@mn.usda.gov">brian.jensen@mn.usda.gov</a>

**MLRA Staff:**

**507-373-5607 Ext. 3**

Clayton Johnson	MLRA 103 Leader	<a href="mailto:clayton.johnson@mn.usda.gov">clayton.johnson@mn.usda.gov</a>
Dan Nath	MLRA	<a href="mailto:daniel.nath@mn.usda.gov">daniel.nath@mn.usda.gov</a>
Kyle Steele	MLRA	<a href="mailto:kyle.steele@mn.usda.gov">kyle.steele@mn.usda.gov</a>

**DU Staff:**

**507-373-5607 Ext. 3**

Tony Reali	WRP Contract Biologist	<a href="mailto:tony.reali@mn.usda.gov">tony.reali@mn.usda.gov</a>
------------	------------------------	--

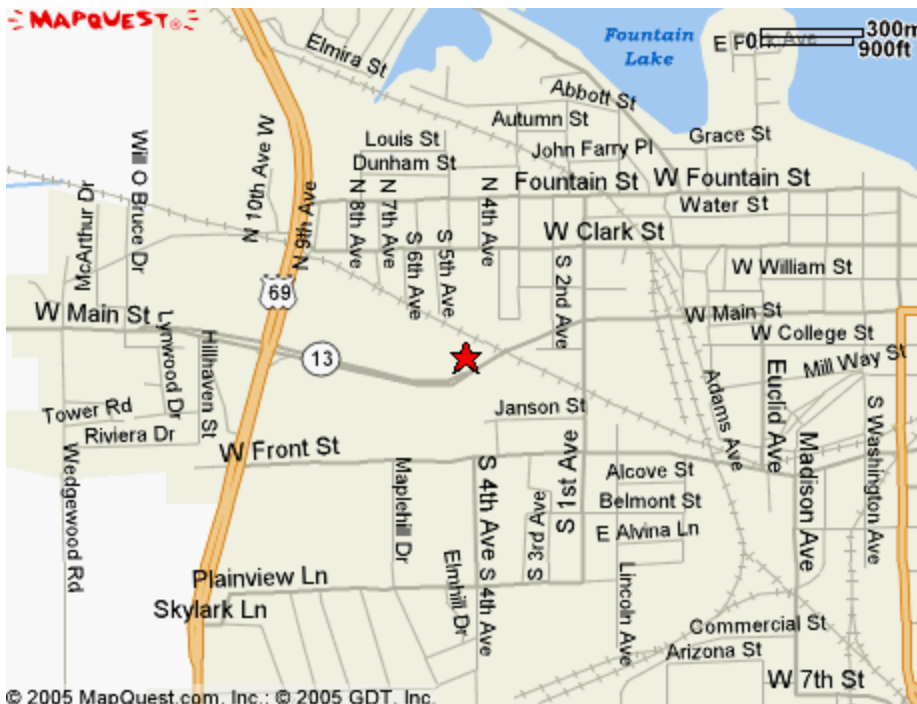

© 2005 MapQuest.com, Inc.; © 2005 GDT, Inc.

**\*\*Emergency Contact:**

Brenda Lageson      507-383-5393

**Goodhue SWCD** – 104 E 3<sup>rd</sup> Ave, PO Box 335, Goodhue, MN 55027  
 651-923-5300, Ext. 4      FAX 651-923-5304      [www.goodhueswcd.org](http://www.goodhueswcd.org)

**Staff:**

Glen Roberson	District Manager	<a href="mailto:groberson@goodhueswcd.org">groberson@goodhueswcd.org</a>
Chris Fritz	District Technician	<a href="mailto:cfritz@goodhueswcd.org">cfritz@goodhueswcd.org</a>
Coty Hyllengren	District Technician	<a href="mailto:chyllengren@goodhueswcd.org">chyllengren@goodhueswcd.org</a>
Beau Kennedy	Water Plan/WCA	<a href="mailto:bkennedy@goodhueswcd.org">bkennedy@goodhueswcd.org</a>
Virginia Westlie	Feedlot Officer	<a href="mailto:vwestlie@goodhueswcd.org">vwestlie@goodhueswcd.org</a>
Christine Wagner	Administrative Assistant	<a href="mailto:cwagner@goodhueswcd.org">cwagner@goodhueswcd.org</a>

**Meeting:**      4<sup>th</sup> Monday of Month :(April – November) 7:30 pm;  
                          Tuesday after 4<sup>th</sup> Monday (December – March) 9:00 AM

**Board Members:**

Donald Banks	507-263-5540		1310 North 6 <sup>th</sup> Street, Cannon Falls MN 55009
John Jaeger	651-388-3977		28135 Co. 2 Blvd, Red Wing MN 55066
Ed McNamara	651-923-4777	<a href="mailto:edmcnamara@sleepyeyetel.net">edmcnamara@sleepyeyetel.net</a>	37299 171 Ave, Goodhue MN 55027
Larry Thomforde	507-732-7074	<a href="mailto:thomforde@deskmedia.com">thomforde@deskmedia.com</a>	17468 Sugarloaf Pky, Zumbrota MN 55992
Paul Voxland	507-789-6410	<a href="mailto:prvoxland@myclearwave.net">prvoxland@myclearwave.net</a>	43625 Co. 30 Blvd, Kenyon MN 55946

**SE SWCD Technical Support JPB Staff**

Kate Bruss      Engineer-In-Training      [kbruss@goodhueswcd.org](mailto:kbruss@goodhueswcd.org)

**NRCS Staff:** 651-923-5300

Thomas Steger	District Con	<a href="mailto:thomas.steger@mn.usda.gov">thomas.steger@mn.usda.gov</a>
Colin Williams	Soil Con Tech	<a href="mailto:colin.williams@mn.usda.gov">colin.williams@mn.usda.gov</a>
Andrea Horsman	Soil Conservationist	<a href="mailto:andrea.horsman@mn.usda.gov">andrea.horsman@mn.usda.gov</a>

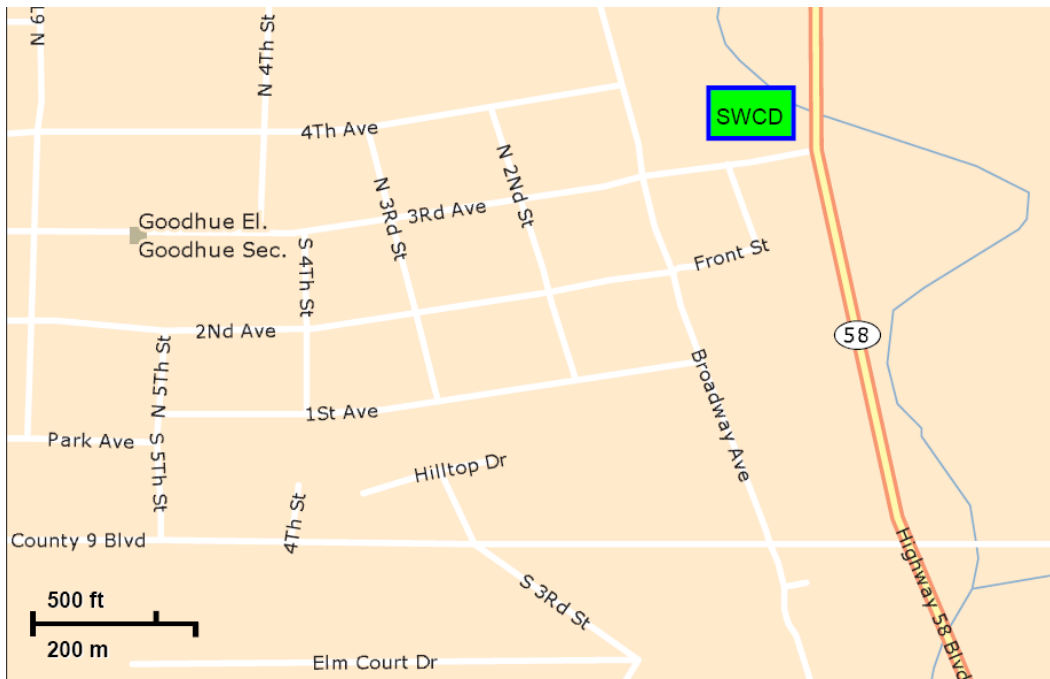

\*\*Emergency Contact: Glen Roberson      507-421-1576

**Mower SWCD** – 1408 21<sup>st</sup> Ave NW Ste 2, Austin, MN 55912-9348  
507-434-2603 FAX 507-434-2680 [www.mowerswcd.org](http://www.mowerswcd.org)

**Staff:**

Bev Nordby	District Manager	<a href="mailto:bev.nordby@mowerswcd.org">bev.nordby@mowerswcd.org</a>
Jeanne Crump	Administrative Assistant	<a href="mailto:jeanne.crump@mn.nacdnet.net">jeanne.crump@mn.nacdnet.net</a>
Justin Hanson	Resource Specialist	<a href="mailto:justin.hanson@mowerswcd.org">justin.hanson@mowerswcd.org</a>
Matt Taylor	Watershed Technician	<a href="mailto:mathew.taylor@mowerswcd.org">mathew.taylor@mowerswcd.org</a>
Cody Fox	District Technician	<a href="mailto:cody.fox@mowerswcd.org">cody.fox@mowerswcd.org</a>
Larry Callahan	District Technician	<a href="mailto:larry.callahan@mn.nacdnet.net">larry.callahan@mn.nacdnet.net</a>

Meeting: 2<sup>nd</sup> Wednesday of Month

**Board Members:**

James Gebhardt	507-477-2184	<a href="mailto:gebhardt59@gmail.com">gebhardt59@gmail.com</a>	31776 State Hwy 56, Waltham, MN 55982
Bill Lonergan, Jr	507-433-4875	<a href="mailto:wmlonergan@myclearwave.net">wmlonergan@myclearwave.net</a>	15443 570 <sup>th</sup> Ave, Austin 55912
Jon Erichson	507-437-2437	<a href="mailto:jerichson@ci.austin.mn.us">jerichson@ci.austin.mn.us</a>	911 18 <sup>th</sup> St SW, Austin 55912
Rick Gehling	507-421-5851	<a href="mailto:rickpeg@hotmail.com">rickpeg@hotmail.com</a>	73498 300 <sup>th</sup> St, Grand Meadow 55936
John Grass, Jr.	507-324-5805		76742 115 <sup>th</sup> St, Le Roy 55951

**NRCS Staff:**

Lisa Buckner	District Con	<a href="mailto:lisa.buckner@mn.usda.gov">lisa.buckner@mn.usda.gov</a>
Adam Arndt	Soil Con Tech	<a href="mailto:adam.arndt@mn.usda.gov">adam.arndt@mn.usda.gov</a>

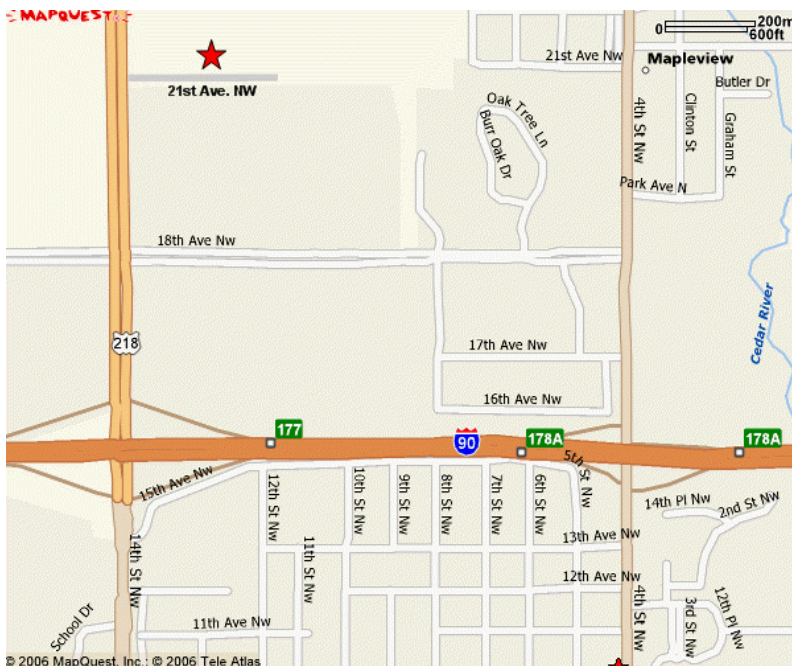

Office Location is actually off of Hwy 218 on eastside

\*\*Emergency Contact: Bev Nordby 507-438-9763

**Olmsted SWCD** – 1485 Industrial Dr NW RM 102, Rochester, MN 55901-0750  
507-280-2850 FAX 507-280-2858 [www.olmstedswcd.org](http://www.olmstedswcd.org)

**Staff:**

Dorothy Miller	District Office Manager	<a href="mailto:dorothy.miller@mn.nacdnet.net">dorothy.miller@mn.nacdnet.net</a>
Floyd Whitaker	District Coordinator	<a href="mailto:floyd.whitaker@mn.nacdnet.net">floyd.whitaker@mn.nacdnet.net</a>
Skip Langer	District Technician	<a href="mailto:skip.langer@mn.nacdnet.net">skip.langer@mn.nacdnet.net</a>
Scott Bennett	District Technician	<a href="mailto:scott.bennett@mn.nacdnet.net">scott.bennett@mn.nacdnet.net</a>
Jim Stannard	Feedlot Technician	<a href="mailto:jim.stannard@mn.nacdnet.net">jim.stannard@mn.nacdnet.net</a>

Meeting: 4<sup>th</sup> Thursday of the Month, Jan-Oct  
3<sup>rd</sup> Thursday of the Month, Nov – Dec at 8 am

**Board Members:**

Paul Uecker	507-282-2419	<a href="mailto:ueckcattle03@yahoo.com">ueckcattle03@yahoo.com</a>	5219 70 <sup>th</sup> Ave NE, Rochester, MN 55906
Steve Connelly	507-261-4386	<a href="mailto:sconnelly56@aol.com">sconnelly56@aol.com</a>	PO Box 681, Byron, MN 55920
Andy Hart	507-876-2256	<a href="mailto:agco21@gmail.com">agco21@gmail.com</a>	10723 Co Rd 11 NE, Elgin, MN 55932
George Poch	507-282-7022	<a href="mailto:gapoch@hotmail.com">gapoch@hotmail.com</a>	1639 5 <sup>th</sup> Ave SE, Rochester, MN 55904
John Keefe	507-932-4656	<a href="mailto:jkmgkeefe@yahoo.com">jkmgkeefe@yahoo.com</a>	15963 Hwy 14 SE, Dover, MN 55929

**NRCS Staff:** 507-282-6153

Mike Muzzy	District Con	<a href="mailto:michael.muzzy@mn.usda.gov">michael.muzzy@mn.usda.gov</a>
Lisa Curtis	Soil Conservationist	<a href="mailto:lisa.curtis@mn.usda.gov">lisa.curtis@mn.usda.gov</a>
Charlie Blackburn	Soil Con Tech	<a href="mailto:Charlie.blackburn@mn.usda.gov">Charlie.blackburn@mn.usda.gov</a>

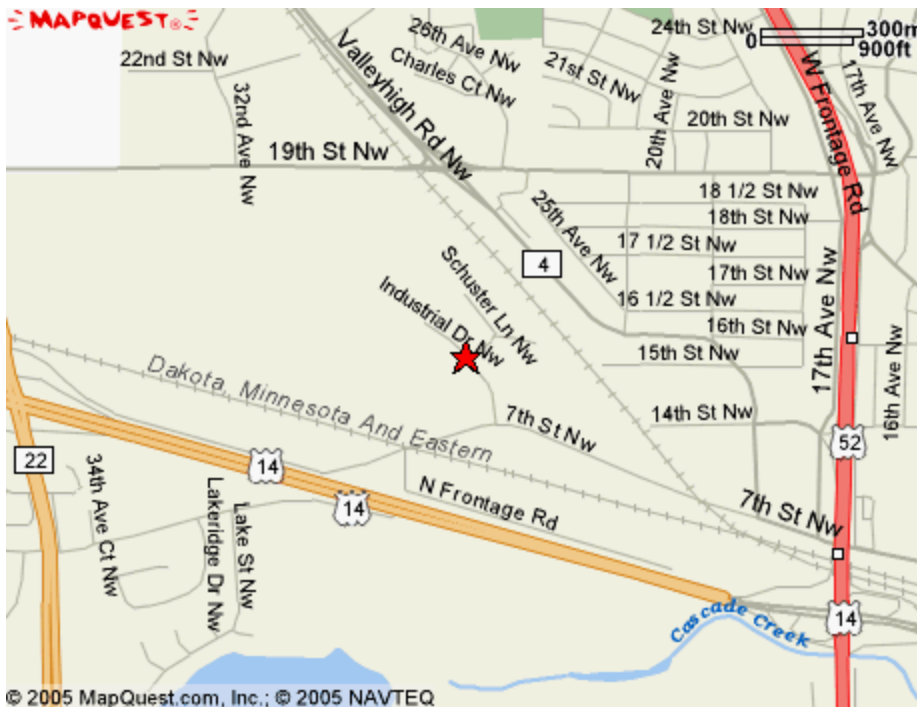

\*\*Emergency Contact: Floyd Whitaker 507-285-0982

**Rice SWCD** – 1810 30<sup>th</sup> St NW, Faribault, MN 55021-1843  
507-332-5408 FAX 507-332-9892 [www.riceswcd.org](http://www.riceswcd.org)

**Staff:**

Steven Pahs	District Manager	<a href="mailto:steven.pahs@mn.nacdnet.net">steven.pahs@mn.nacdnet.net</a>
Tim Labs	District Program Manager	<a href="mailto:tim.labs@mn.nacdnet.net">tim.labs@mn.nacdnet.net</a>
Debbie Skarupa	Administrative Assistant	<a href="mailto:debbie.skarupa@mn.nacdnet.net">debbie.skarupa@mn.nacdnet.net</a>
Danielle Waldschmidt	Farm Bill Technician	<a href="mailto:danielle.waldschmidt@mn.nacdnet.net">danielle.waldschmidt@mn.nacdnet.net</a>
Kathrine Richards	Nutrient Mgmt Specialist	<a href="mailto:Kathrine.richards@mn.nacdnet.net">Kathrine.richards@mn.nacdnet.net</a>

Meeting: 3rd Wednesday of the Month at 1:30pm.

**Board Members:**

Dale Neirby	507-334-8045	<a href="mailto:dale.neirby@bah.state.mn.us">dale.neirby@bah.state.mn.us</a>	807 Vardon Court, Faribault 55021
Robert Duban	507-645-8024		12084 Bagley Ave, Dundas 55019
Jim Purfeerst	507-334-3552	<a href="mailto:jpurfeerst@myclearwave.net">jpurfeerst@myclearwave.net</a>	7803 240 St. E, Faribault 55021
Richard Huston	507-332-8533	<a href="mailto:dvmhuston@yahoo.com">dvmhuston@yahoo.com</a>	4425 195 <sup>th</sup> St W, Faribault 55021
Gary Wagenbach	507-645-8549	<a href="mailto:gwagenba@gmail.com">gwagenba@gmail.com</a>	10400 Jenkins Trail, Nerstrand 55053

**NRCS Staff:** 507-334-1887

Tom Coffman	District Con	<a href="mailto:thomas.coffman@mn.usda.gov">thomas.coffman@mn.usda.gov</a>
Kelly Oliver	Soil Tech	<a href="mailto:kelly.oliver@mn.usda.gov">kelly.oliver@mn.usda.gov</a>

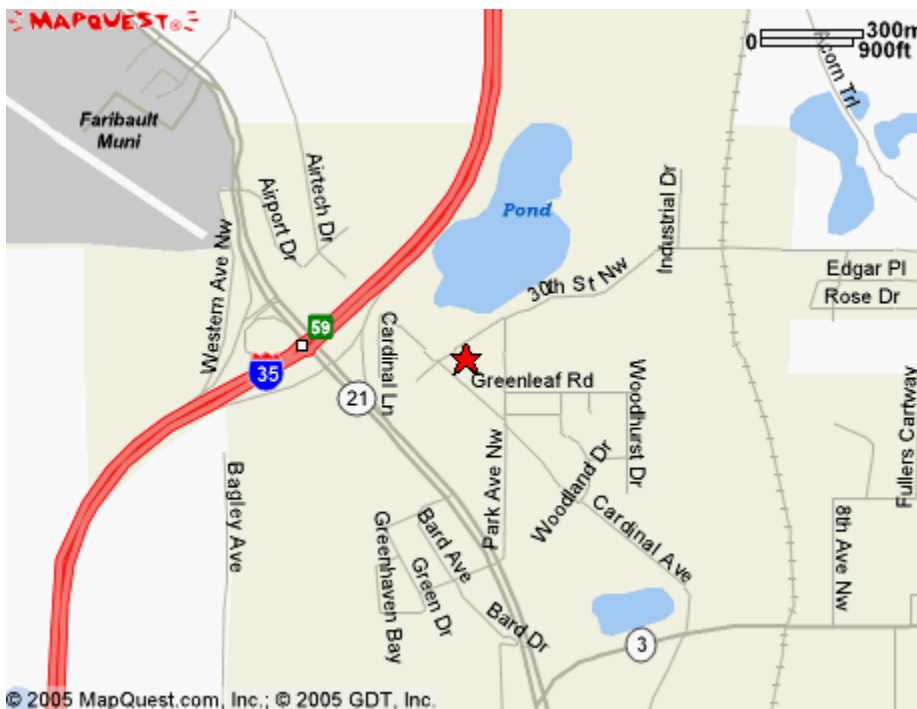

\*\*Emergency Contact: Steve Pahs (cell phone) 507-993-8375

**Root River SWCD** – 805 N. Hwy. 44/76, Suite 1, Caledonia, MN 55921

507-724-5261, Ext. 3      FAX 507-724-5448    <http://www.houstoncounty.govoffice2.com> (then click on “County Offices and Departments”, then “Soil & Water Conservation District”)

**Staff:**

Ralph Tuck (retiring Feb 23 2012)	District Manager	<a href="mailto:ralph.tuck@mn.nacdnet.net">ralph.tuck@mn.nacdnet.net</a>
Ronald Meiners	Soil Conservationist	<a href="mailto:ronald.meiners@mn.nacdnet.net">ronald.meiners@mn.nacdnet.net</a>
Janice Messner	Administrative Assistant	<a href="mailto:janice.messner@mn.nacdnet.net">janice.messner@mn.nacdnet.net</a>
Richard Stemper	District Technician	<a href="mailto:richard.stemper@mn.nacdnet.net">richard.stemper@mn.nacdnet.net</a>
Dave Walter	District Technician	<a href="mailto:dave.walter@mn.nacdnet.net">dave.walter@mn.nacdnet.net</a>

Meeting: 2<sup>nd</sup> Wednesday of the Month at 8:30 am

**Board Members:**

Tony Becker	608-406-1043	11721 Ridgeview Rd, Caledonia, MN 55921
Vernon Fruechte	507-724-2524	18418 Simmental Rd, Caledonia, MN 55921
Glenn Kinneberg	507-498-5157	14824 County 17, Spring Grove, MN 55974
Joe McManimon	507-864-7439	211860 County 13, Houston, MN 55943
Douglas Meyer	507-895-8879	906 Redwood E, LaCrescent, MN 55947

**SE SWCD Technical Support JPB Staff**

Jason Rochester      JPB Feedlot Tech      [Jason.rochester@mn.nacdnet.net](mailto:Jason.rochester@mn.nacdnet.net)

**NRCS Staff:** 507-724-5261, Ext. 3

Gary Larson	District Con	<a href="mailto:gary.larson2@mn.usda.gov">gary.larson2@mn.usda.gov</a>
Lance Klessig	Soil Con Tech	<a href="mailto:lance.klessig@mn.usda.gov">lance.klessig@mn.usda.gov</a>

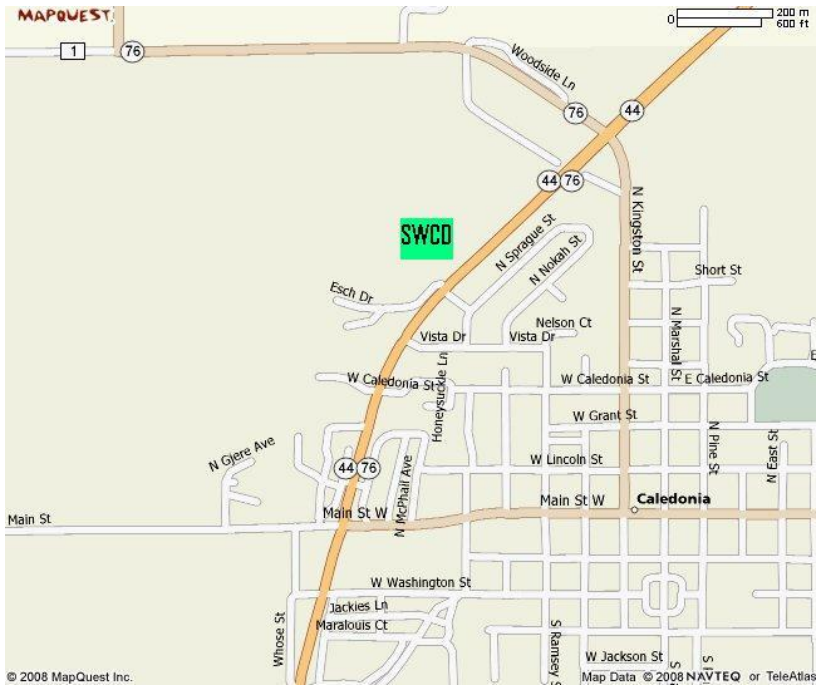

\*\*Emergency Contact: Ron Meiners      563-497-3143

**Steele SWCD** – 235 Cedardale Dr SE, Owatonna, MN 55060-4417  
507-451-6730 FAX 507-444-2421 <http://www.steeleswcd.org>

**Staff:**

Dan Arndt	District Manager	<a href="mailto:dan.arndt@mn.nacdnet.net">dan.arndt@mn.nacdnet.net</a>
Sue Condon	Administrative Assistant	<a href="mailto:sue.condon@mn.nacdnet.net">sue.condon@mn.nacdnet.net</a>
Eric Gulbransen	District Technician	<a href="mailto:eric.gulbransen@mn.nacdnet.net">eric.gulbransen@mn.nacdnet.net</a>
Danielle Waldschmidt	Farm Bill Technician	<a href="mailto:danielle.waldschmidt@mn.nacdnet.net">danielle.waldschmidt@mn.nacdnet.net</a>

Meeting: 2<sup>nd</sup> Wednesday of Month at 7:00 pm

**Board Members:**

Mark Ihlenfeld	507-451-5864	<a href="mailto:Ihlenfeld@Myclearwave.net">Ihlenfeld@Myclearwave.net</a>	6148 NW 50 <sup>th</sup> St, Owatonna, MN 55060-9307
Kyle Wolfe	507-451-6139	<a href="mailto:KNWOLFE@Q.com">KNWOLFE@Q.com</a>	2980 Northridge Ln NE, Owatonna, MN 55060
James Klecker	507-451-0129	<a href="mailto:mikeklecker@myclearwave.net">mikeklecker@myclearwave.net</a>	3071 SE 108 <sup>th</sup> St, Owatonna, MN 55060
Dave Melby	507-451-4904		4825 SE 38 <sup>th</sup> St, Owatonna, MN 55060
Dan Hansen	507-451-1191	<a href="mailto:dhansen@eei.com">dhansen@eei.com</a>	711 SW 75 <sup>th</sup> St, Ellendale, MN 56026

**NRCS Staff:** 507-451-1054

Noel Frank	District Con	<a href="mailto:noel.frank@mn.usda.gov">noel.frank@mn.usda.gov</a>
James Smith	Soil Con Tech	<a href="mailto:james.smith@mn.usda.gov">james.smith@mn.usda.gov</a>



\*\*Emergency Contact: Sue Condon 507-456-5279

**Wabasha SWCD** – 611 Broadway Ave Ste 10, Wabasha, MN 55981-1600

651-565-4673 FAX 651-565-2630 <http://www.wabashaswcd.com>

**Staff:**

Jennifer George (vacant)	District Manager Water Plan Coordinator	<a href="mailto:jsgeorge@wabasha.net">jsgeorge@wabasha.net</a>
Donald Sylvester	District Technician	<a href="mailto:donald.sylvester@mn.nacdnet.net">donald.sylvester@mn.nacdnet.net</a>
Terri Peters	Administrative Assistant	<a href="mailto:terri.peters@mn.nacdnet.net">terri.peters@mn.nacdnet.net</a>
Matt Kruger	Feedlot Technician	<a href="mailto:matt.kruger@mn.nacdnet.net">matt.kruger@mn.nacdnet.net</a>

Meeting: 4<sup>th</sup> Tuesday of the Month at 8:00 AM

**Board Members:**

Chuck Fick	507-534-2219	57569 275 <sup>th</sup> Ave, Plainview, MN 55964
Ralph Breuer	651-345-3651	69022 310 <sup>th</sup> Ave, Lake City, MN 55041
Tom Gosse	651-565-4597	511 E 2 <sup>nd</sup> St, Wabasha, MN 55981
Roland Wood	507-534-2384	22060 Co Rd 27, Plainview, MN 55964
Nate Arendt	507-843-5321 <a href="mailto:arendtholsteins@aol.com">arendtholsteins@aol.com</a>	66272 430 <sup>th</sup> Ave, Mazeppa, MN 55956

**NRCS Staff:** 651-565-3345

James Fritz	District Con	<a href="mailto:james.fritz@mn.usda.gov">james.fritz@mn.usda.gov</a>
Raelene Marquez	Soil Con Tech	<a href="mailto:raelene.marquez@mn.usda.gov">raelene.marquez@mn.usda.gov</a>



\*\*Emergency Contact: Jenny George Cell: 651-380-4760

**Winona SWCD** – PO Box 39, Lewiston, MN 55952-0039  
 507-523-2171, Ext. 3      FAX 507-523-3717      [www.winonaswcd.org](http://www.winonaswcd.org)

**SWCD Staff:**

Daryl Buck	District Manager	<a href="mailto:daryl.buck@winonaswcd.com">daryl.buck@winonaswcd.com</a>	
Brein Maki	Office Administrator	<a href="mailto:brein.maki@winonaswcd.com">brein.maki@winonaswcd.com</a>	
Amanda Gentry	Feedlot Engineer Technician	<a href="mailto:amanda.gentry@winonaswcd.com">amanda.gentry@winonaswcd.com</a>	Ext. 114
Mark Root	Resource Specialist	<a href="mailto:mark.root@winonaswcd.com">mark.root@winonaswcd.com</a>	

**Meeting:** 2<sup>nd</sup> Wednesday of Month at 9:00 am

**Board Members:**

Lonny Dietz	507-932-5225	<a href="mailto:londietz@aol.com">londietz@aol.com</a>	17485 Calico Hill Road, Altura MN 55910
Arlene Nelson	507-796-6233	<a href="mailto:anelson69@centurylink.net">anelson69@centurylink.net</a>	19675 Co Rd 33, Altura, MN 55910
Eric Nelson	507-474-2422	<a href="mailto:eric09nels@gmail.com">eric09nels@gmail.com</a>	551 East Sanborn St, Winona MN 55987
Jim Riddle, Chair (Vacant)	507-454-8310	<a href="mailto:jriddle@riverland.org">jriddle@riverland.org</a>	31762 Wiscoy Ridge Road, Winona, MN 55987

**SE SWCD Technical Support JPB Staff**

Pete Fryer      JPB Engineer      [pfryer@winonaswcd.com](mailto:pfryer@winonaswcd.com)

**Whitewater Watershed Joint Powers Board:** 507-523-2171 ext 110      Meeting: 2<sup>nd</sup> Thursday

Natalie Siderius	Project Coordinator	<a href="mailto:nsiderius@co.winona.mn.us">nsiderius@co.winona.mn.us</a>
Jerome Hildebrandt	Outreach Coordinator	

**NRCS Staff:**

Sue Glende	District Conservationist	<a href="mailto:sue.glende@mn.usda.gov">sue.glende@mn.usda.gov</a>
Justin Lindner	Soil Conservationist	<a href="mailto:justin.lindner@mn.usda.gov">justin.lindner@mn.usda.gov</a>
Dave Dockter	Soil Conservation Tech	<a href="mailto:david.dockter@mn.usda.gov">david.dockter@mn.usda.gov</a>

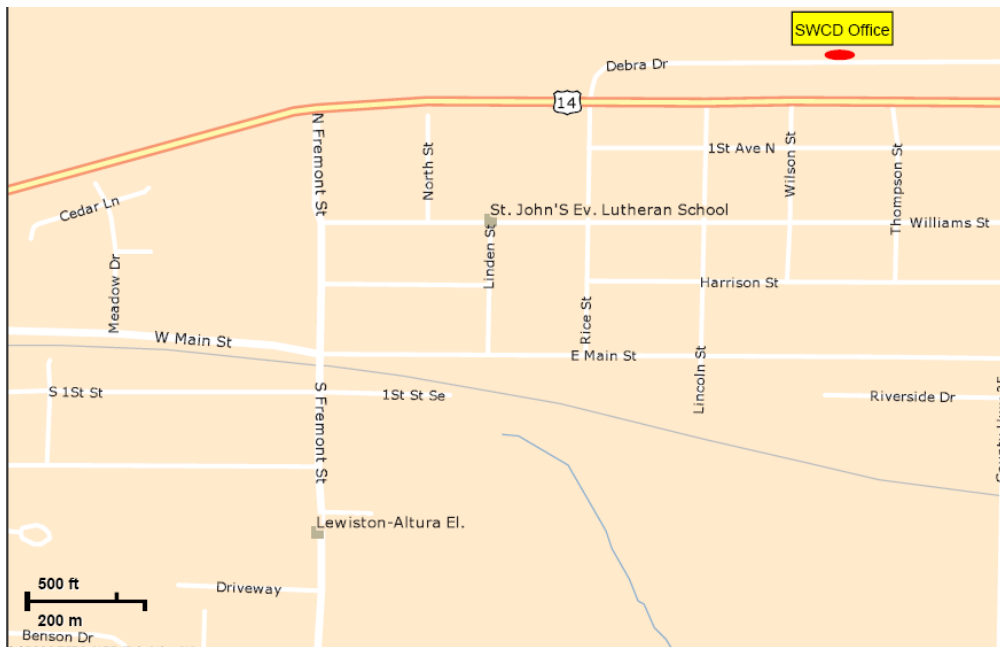

**\*\*Emergency Contact:**      Daryl Buck (507) 269-2108 or Bree Maki (507) 429-0942

## Watershed Partnerships:

### Cannon River Watershed Partnership:

Cannon River Watershed Partnership  
8997 Eaves Ave  
Northfield, MN 55057

Phone: 507-786-8400  
Fax: 507-786-8039

Beth Kallestad	Executive Director	<a href="mailto:beth@crwp.net">beth@crwp.net</a>
Lucas Bistodeau	Water Monitoring Program Coordinator	<a href="mailto:lucas@crwp.net">lucas@crwp.net</a>
Sheila Craig	- Community Sewage Treatment Facilitator	<a href="mailto:scraig@co.fillmore.mn.us">scraig@co.fillmore.mn.us</a>
Leslie Kennedy	- Administrative Assistant	<a href="mailto:leslie@crwp.net">leslie@crwp.net</a>
Aaron Wills	- Com. Sewage Treatment Facilitator	<a href="mailto:aaron@crwp.net">aaron@crwp.net</a>

<http://www.crwp.net/>

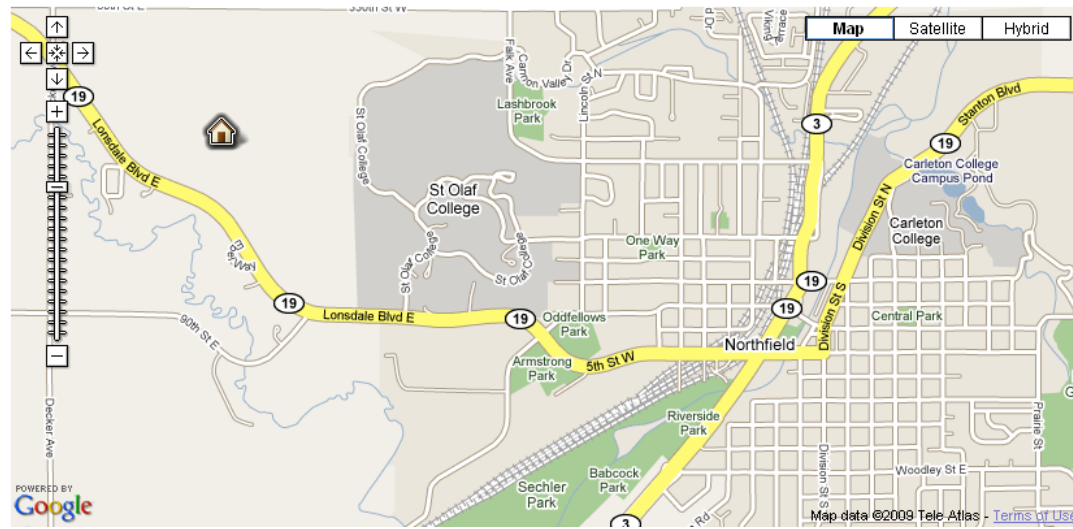

### Cedar River Watershed District

1408 21<sup>st</sup> Ave. NW, Austin MN 55912 507-434-2603 [www.cedarriverwd.org](http://www.cedarriverwd.org)  
(located at Mower SWCD: see them for details)

### Whitewater Watershed Joint Powers Board

(see Winona SWCD for details)

# Southeast Minnesota Water Resources Board

Southeast Minnesota Water Resources Board  
Winona State University  
PO Box 5838  
Winona, MN 55987

Phone: 507-457-5223  
FAX: 507-457-2840  
Email: [ldahl@winona.edu](mailto:ldahl@winona.edu)  
Web: [www.winona.edu/geology/WRB/WRB](http://www.winona.edu/geology/WRB/WRB)

Linda Dahl, Executive Director

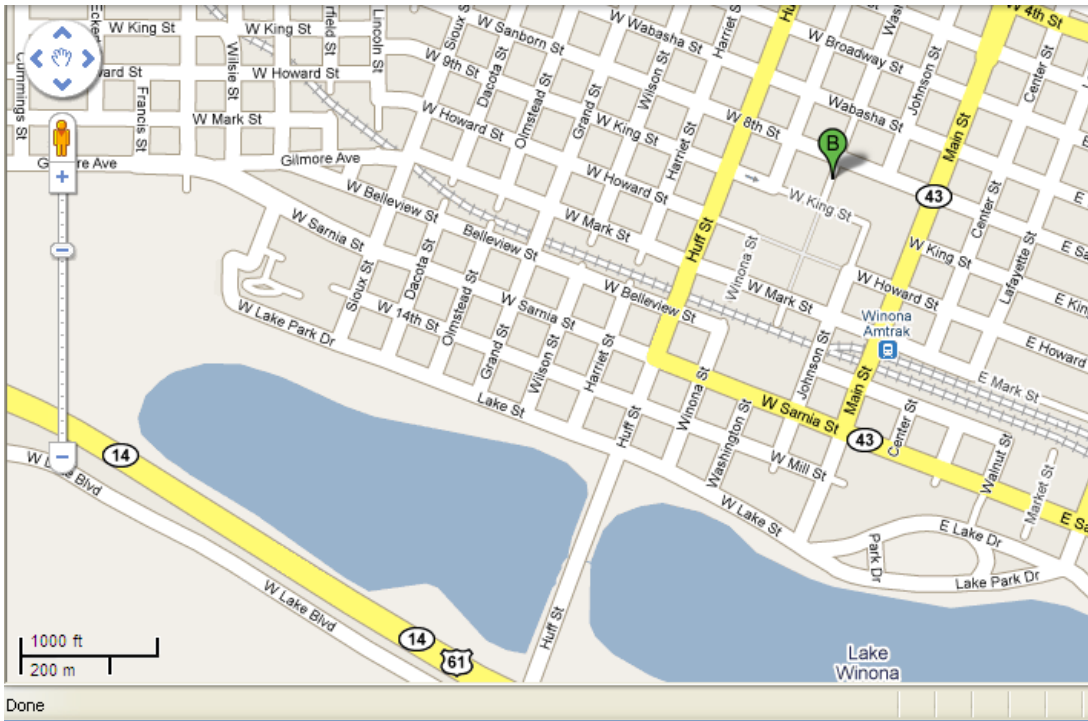

## Zumbro Watershed Partnership:

Zumbro Watershed Partnership, Inc.  
1485 Industrial Drive NW Room 102  
Rochester, MN 55901

Lisa Eadens: Watershed Outreach Coordinator:  
Office: 507-280-2850 Cell: 507-226-6787

Kevin Strauss: Outreach & Education; [education@zumbrowatershed.org](mailto:education@zumbrowatershed.org)

Ron Fuller: Chair;  
Rochester office: 507-280-2850  
Fax: 507-280-2858  
Email: [admin@zumbrowatershed.org](mailto:admin@zumbrowatershed.org)

<http://www.zumbrowatershed.org/>

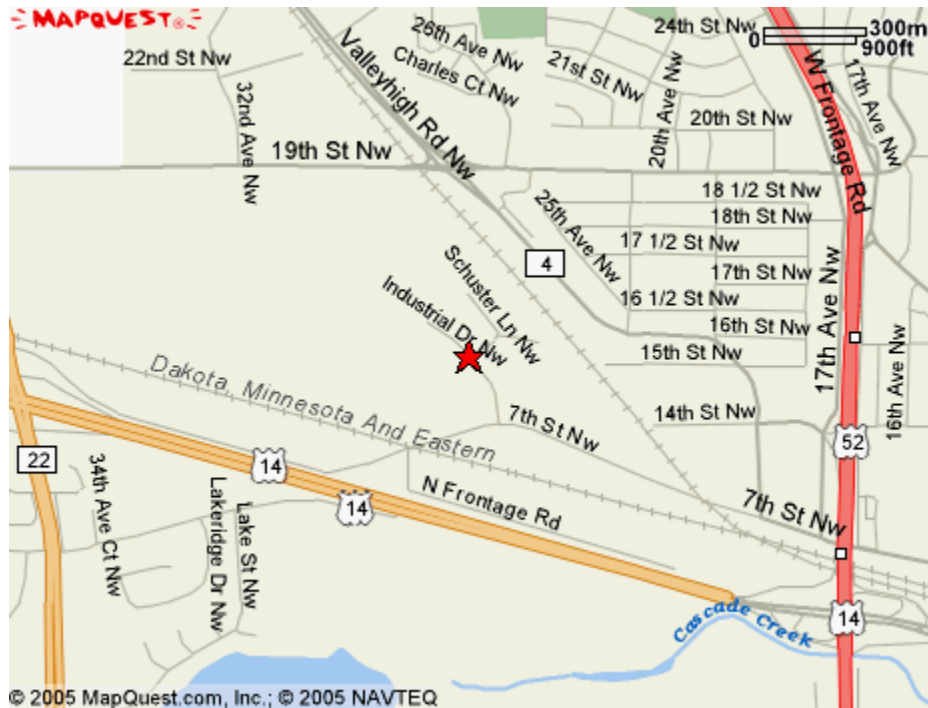

## **BWSR (Board of Water & Soil Resources)**

2300 Silver Creek Rd NE  
Rochester, MN 55906-4505

507-206-2889 Fax: 507-285-7144 Web site: [www.bwsr.state.mn.us](http://www.bwsr.state.mn.us)

Mary Kells Board Conservationist [Mary.Kells@state.mn.us](mailto:Mary.Kells@state.mn.us)  
507-206-2890

Steve Lawler Wetland Specialist [Steve.Lawler@state.mn.us](mailto:Steve.Lawler@state.mn.us)  
507-206-2891 Cell: 507-696-3617

Dorothy Erickson Secretary [Dorothy.I.Erickson@state.mn.us](mailto:Dorothy.I.Erickson@state.mn.us)  
507-206-2889

Terry Ragan Engineer [Terry.ragan@state.mn.us](mailto:Terry.ragan@state.mn.us)  
507-206-2892 Cell: 507-450-3644 (in Rochester thru 6/30/12, then will report daily to St Paul)

Jesse Preston Engineering Tech [Jesse.Preston@state.mn.us](mailto:Jesse.Preston@state.mn.us)  
507-206-2893 Cell: 507-273-4678 (in Rochester thru 6/30/12, then will report daily to St Paul)

Kyle Skov Con. Drainage Engineer [Kyle.Skov@state.mn.us](mailto:Kyle.Skov@state.mn.us)  
507-206-2894 Cell: 507-491-6804

### **Southern Region Specialists:**

Matt Drewitz CWL Project Team Leader [matt.drewitz@state.mn.us](mailto:matt.drewitz@state.mn.us)  
Cell: 507-766-5020

Jeremy Maul Sr. Wetland Specialist [Jeremy.maul@state.mn.us](mailto:Jeremy.maul@state.mn.us)  
507-389-1967 Cell: 507-380-4047

Chris Hughes Board Conservationist [chris.hughes@state.mn.us](mailto:chris.hughes@state.mn.us)  
507-389-6784 Cell: 507-381-5040

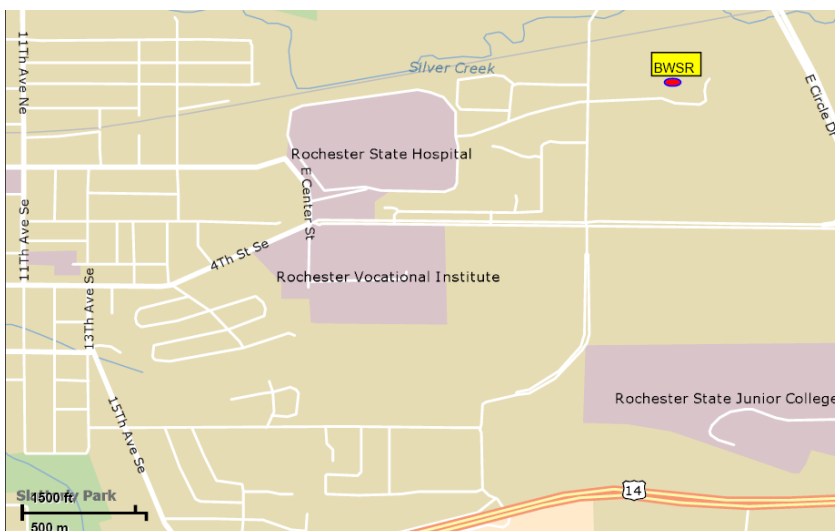

# Board Conservationist Work Areas

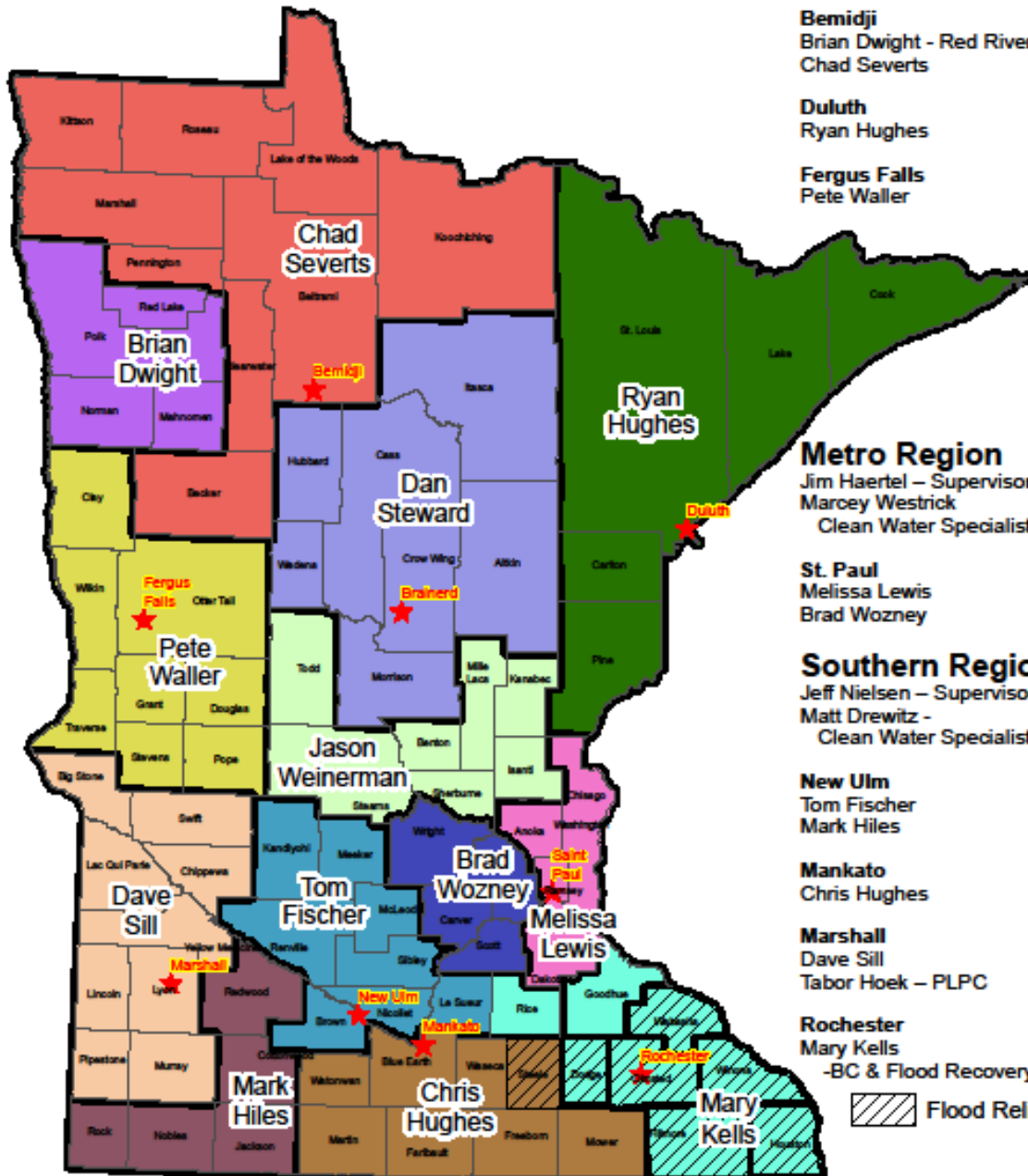

## Northern Region

Ron Shelito - Supervisor (218) 828 - 2604  
 Jeff Hrubes - Clean Water Specialist (218) 833 - 8808

**Brainerd** (218) 828 - 2383  
 Dan Steward (218) 828 - 2598  
 Jason Weinerman (218) 828 - 6045

**Bemidji** (218) 755 - 4235  
 Brian Dwight - Red River (218) 333 - 8027  
 Chad Severts (218) 333 - 8028

**Duluth** (218) 723 - 4752  
 Ryan Hughes (218) 723 - 4923

**Fergus Falls** (218) 736 - 5445  
 Pete Waller

## Metro Region

Jim Haertel - Supervisor (651) 297 - 2906  
 Marcey Westrick Clean Water Specialist (651) 284 - 4153

**St. Paul** (651) 296 - 3767  
 Melissa Lewis (651) 297 - 4735  
 Brad Wozney (651) 296 - 6068

## Southern Region

Jeff Nielsen - Supervisor (507) 359 - 6075  
 Matt Drewitz - Clean Water Specialist (507) 359 - 6078

**New Ulm** (507) 359 - 6074  
 Tom Fischer (507) 359 - 8091  
 Mark Hiles (507) 359 - 6077

**Mankato** (507) 389 - 6784  
 Chris Hughes

**Marshall** (507) 537 - 6060  
 Dave Sill (507) 537 - 6374  
 Tabor Hoek - PLPC (507) 537 - 7260

**Rochester** (507) 206 - 2889  
 Mary Kells (507) 206 - 2890

-BC & Flood Recovery  
 Flood Relief Counties

**Central Office:**  
 520 Lafayette Road North  
 Saint Paul, MN 55155  
 Phone: (651) 296-3767  
 Fax: (651) 297-5615

[WWW.BWSR.STATE.MN.US](http://WWW.BWSR.STATE.MN.US)



March 2010

# Wetland Conservation Act Work Areas

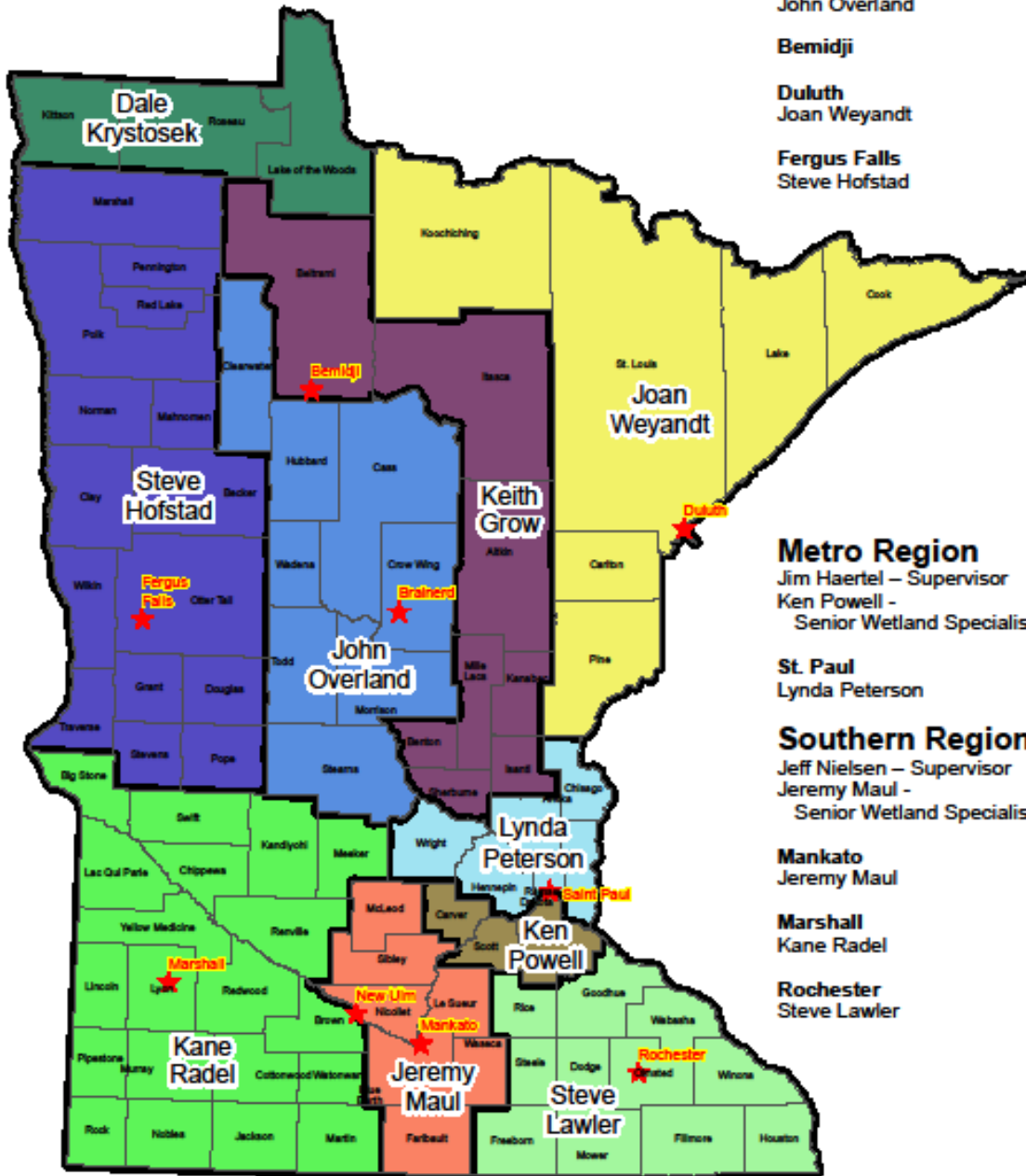

## Northern Region

Ron Shelito - Supervisor (218) 828 - 2604  
Dale Krystosek - Senior Wetland Specialist (218) 333 - 8029

**Brainerd** (218) 828 - 2383  
Keith Grow (218) 828 - 8035  
John Overland (218) 825 - 8807

**Bemidji** (218) 333 - 8024

**Duluth** (218) 723 - 4752  
Joan Weyandt (218) 723 - 4607

**Fergus Falls** (218) 736 - 5445 x115  
Steve Hofstad

## Metro Region

Jim Haertel - Supervisor (651) 297 - 2906  
Ken Powell - Senior Wetland Specialist (651) 296 - 0874

**St. Paul** (651) 296 - 3767  
Lynda Peterson (612) 201 - 9806

## Southern Region

Jeff Nielsen - Supervisor (507) 359 - 6075  
Jeremy Maul - Senior Wetland Specialist (507) 389 - 1967

**Mankato** (507) 389 - 1967  
Jeremy Maul

**Marshall** (507) 537 - 6060  
Kane Radel (507) 537 - 7069

**Rochester** (507) 206 - 2889  
Steve Lawler (507) 206 - 2890

WWW.BWSR.STATE.MN.US

Central Office:  
520 Lafayette Road North  
Saint Paul, MN 55155  
Phone: (651) 296-3787  
Fax: (651) 297-5815



October 2010

# NRCS (Natural Resource Conservation Service)

330 Elton Hills Drive NW  
Rochester, MN 55901-2476  
507-289-7454 Fax: 504-289-3742 <http://www.mn.nrcs.usda.gov>

Kasey Taylor	Assistant State Consvst	<a href="mailto:kasey.taylor@mn.usda.gov">kasey.taylor@mn.usda.gov</a>
Doug Christianson	Civil Engineering Tech.	<a href="mailto:douglas.christianson@mn.usda.gov">douglas.christianson@mn.usda.gov</a>
Amy J. Dessner	Civil Engineer	<a href="mailto:amy.dessner@mn.usda.gov">amy.dessner@mn.usda.gov</a>
Willis R. Goll	Agricultural Engineer	<a href="mailto:willis.goll@mn.usda.gov">willis.goll@mn.usda.gov</a>
Peter R. Hartman	Area Resource Soil Scientist	<a href="mailto:peter.hartman@mn.usda.gov">peter.hartman@mn.usda.gov</a>
Mark A. Kanable	Programs Specialist	<a href="mailto:mark.kanable@mn.usda.gov">mark.kanable@mn.usda.gov</a>
Judy K. Lambert	Area Admv Coordinator	<a href="mailto:judy.lambert@mn.usda.gov">judy.lambert@mn.usda.gov</a>
Christopher L. Nelson	Civil Engrg Tech	<a href="mailto:chris.nelson2@mn.usda.gov">chris.nelson2@mn.usda.gov</a>
Elizabeth A. Oolman	Agricultural Engineer	<a href="mailto:elizabeth.oolman@mn.usda.gov">elizabeth.oolman@mn.usda.gov</a>
Aaron Peter	Area Engineer	<a href="mailto:aaron.peter@mn.usda.gov">aaron.peter@mn.usda.gov</a>
Larry W. Peterson	Civil Engrg Tech	<a href="mailto:larry.peterson@mn.usda.gov">larry.peterson@mn.usda.gov</a>
Jayne K. Piepenburg	Accounting Tech	<a href="mailto:jayne.piepenburg@mn.usda.gov">jayne.piepenburg@mn.usda.gov</a>
Christiane C.Schwieder	GIS Specialist	<a href="mailto:christiane.roy@mn.usda.gov">christiane.roy@mn.usda.gov</a>
(Vacant)	Area Resource Consvst	
Mary K. Weis	Civil Engrg Tech	<a href="mailto:mary.weis@mn.usda.gov">mary.weis@mn.usda.gov</a>
Timothy Weisbrod	Geologist	<a href="mailto:tim.weisbrod@mn.usda.gov">tim.weisbrod@mn.usda.gov</a>
John Zinn	Grazing Specialist	<a href="mailto:john.zinn@mn.usda.gov">john.zinn@mn.usda.gov</a>

## ITS Support Staff

Lori Quinnell (Rochester Office) (507) 289-7454 [lori.quinnell@mn.usda.gov](mailto:lori.quinnell@mn.usda.gov)  
(Dodge, Fillmore, Freeborn, Houston, Mower, Olmsted, Steele, Winona)

Nick Wenger (St. Paul Office) 651.583.4378 [Nick.Wenger@mn.usda.gov](mailto:Nick.Wenger@mn.usda.gov)  
(Goodhue, Wabasha)

Rick Killmer (St. Paul Office) 651-602-7788 [Rick.Killmer@mn.usda.gov](mailto:Rick.Killmer@mn.usda.gov)  
(Rice)

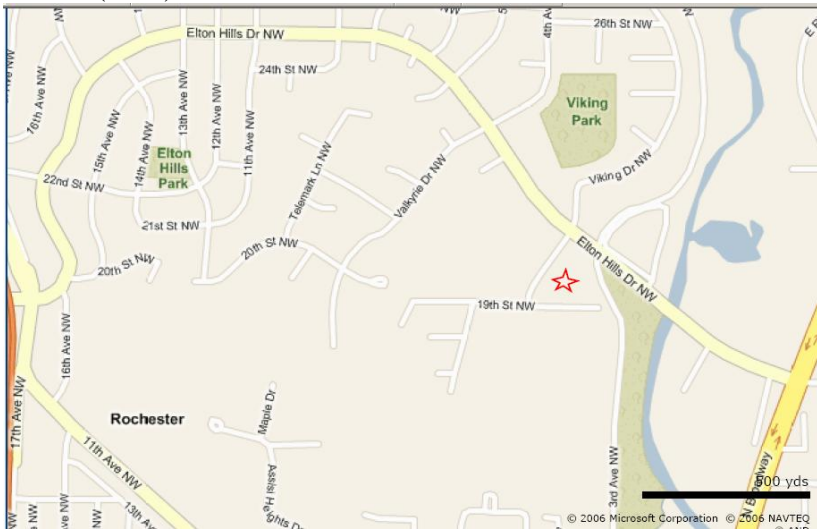



# International Technology Services (ITS)

## Technical Support Division Organization Map - Minnesota

Effective: May 2011

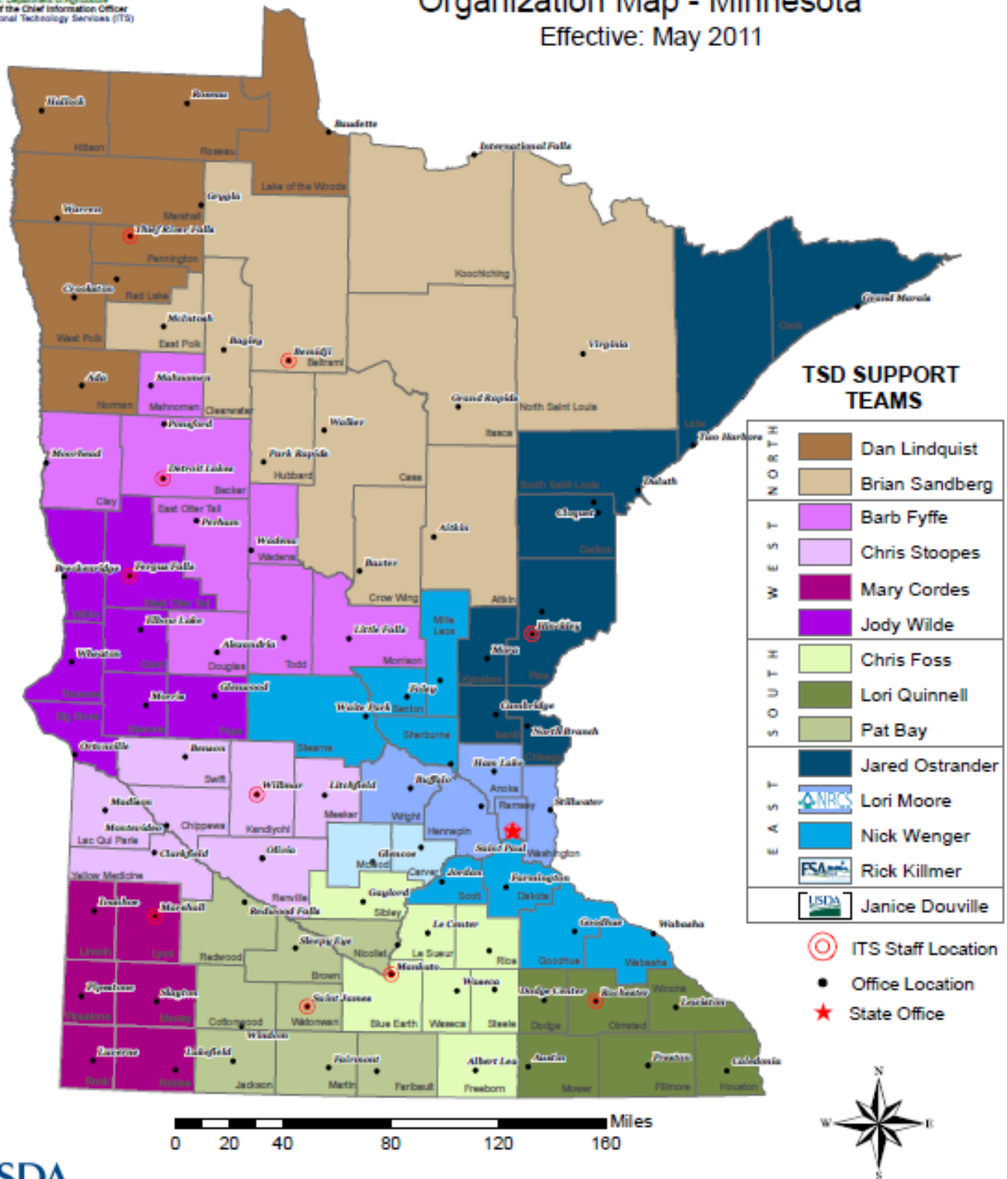

This map is for informational purposes only. There is no guarantee to the user as to the accuracy, currency, suitability or reliability. The USDA/ITS assumes no responsibility for its content.

**ROCHESTER DNR OFFICE STAFF (by discipline)**  
**DEPARTMENT OF AGRICULTURE, BWSR & CONSERVATION CORPS**

**ECOLOGICAL & WATER RESOURCES**

Bradt, Randy Area Hydrologist ..... 206-2851  
 Dick, Sally Office & Administrative Specialist .. 206-2852  
 Edwards, Jaime Nongame Wildlife Specialist ..... 206-2820  
 Green, Jeff Groundwater Specialist, LCCMR Proj 206-2853  
 Hanson, Corey Area Hydrologist ..... 206-2854  
 Johnson, Scot Regional Groundwater Specialist ..... 206-2855  
 Perry, Barb Nongame/Wildlife Technician ..... 206-2821  
 Reber, Nancy Office & Administrative Specialist .. 206-2859

**FISHERIES**

Nelson, Rick ..... 206-2829  
 Schulz, Jamie GIS Fisheries ..... 206-2830

**FORESTRY**

Hinz, Kurt Area Timber Program Leader ..... 206-2835  
 Kelly, John Electronic Burn Permit System ..... 206-2839  
 Rau, Doug Forestry Staff Supervisor ..... 206-2836  
 Sorensen, Lance Utilization and Marketing ..... 206-2837  
 Willson, Jeanne Office Manager ..... 206-2838

**PARKS AND TRAILS**

Anderson, Linden Resource Technician ..... 206-2865  
 Arnold, Mike T & W Technician ..... 206-2844  
 Blommer, Craig Area Supervisor ..... 206-2845  
 Hemmingsen, Kevin T & W Specialist ..... 206-2846  
 Nelson, Jane Office & Administrative Specialist .. 206-2847  
 Wagar, Joel Area Supervisor ..... 206-2848  
 Wunrow, Aaron Regional Parks Op Supervisor ..... 206-2841

**WILDLIFE**

Nelson, Don Area Supervisor ..... 206-2858  
 Perry, Barb Nongame/Wildlife Technician ..... 206-2821  
 Reber, Nancy Office & Administrative Specialist .. 206-2859  
 Tannahill, Leslie Grants Specialist ..... 206-2861  
 Tenney, Mike Assistant Area Wildlife Manager ..... 206-2862

**MISCELLANEOUS**

Access Voicemail Away From Office (2 options)  
 ..... dial 651/556-7600 or  
*dial your office #, press 9 when you hear your greeting, follow prompts*  
 Break Room 280-5083 (wall phone) \*\* 206-2865 (not in  
 use)  
 Conference Room (conf. phone located in Stan's office) 280-5083\*\*

Camp Ripley (safety classes & certificates) .....800-366-8917  
 Computer, Network or GIS problems (MIS Service Desk Plus)  
 e-mail: *computersupport.dnr@state.mn.us*  
 internet site: *http://computersupport.dnr.state.mn.us*  
 ..... 651/259-5900

Conservation Officers (patrol areas) .....  
*www.dnr.state.mn.us/officerpatrolareas/index*

Duty Office .....800-422-0798  
 PCA (Rochester) ..... 285-7343  
 PCA (toll free) .....800-657-3864

Elevator ..... 281-7776

Fax Machine ..... 285-7144

Communication & Outreach (Info Center) .....888-646-6367

Instant License ..... 888-MNLicense (888-665-4236)

Internet DNR web site ..... *dnr.state.mn.us* or *mndnr.gov*

Lobby ..... 206/2866

Park Reservation line ..... 866-85PARKS (866-857-2757)

Raptor Center ..... 612/624-4745

TIP Hotline ..... 800-652-9093

Wildlife Rehab ..... 651/486-9453

**DEPARTMENT OF AGRICULTURE**

Benson, Mike ..... 206-2880  
 Birr, Adam ..... 206-2881  
 Tollefson, Dave ..... 206-2882

**BWSR**

Erickson, Dorothy ..... 206-2889  
 Kells, Mary ..... 206-2890  
 Lawler, Steve ..... 206-2891  
 Peterson, Dave ..... 218/556-4686  
 Preston, Jesse ..... 206-2893  
 Ragan, Terry ..... 206-2892  
 Skove, Kyle ..... 206-2894

**CONSERVATION CORPS**

Krause, Jake Crew Leader – Maples ..... cell 507/276-6172  
 Friedmeyer, Joseph Crew Leader – Cedars .... cell 507/951-0283  
 Johnson, Andy Crew Leader – Oaks ..... cell 507/276-0863  
 Looman, Dustin Asst District Mgr ..... 206-2896  
 ..... cell 507/276-0677  
 Martin, Kyle Field Assistant ..... cell 507/276-0676  
 Varner, Joel Crew Leader – Pines ..... cell 507/276-6170

8/19/11 Rochester IP phones users to dial “9-1” for all long-distance calls except between offices with IP phones (Bemidji, Hibbing Lands and Minerals, Central Office and St. Paul Regional Office).

**LAKE CITY DNR OFFICE STAFF (by discipline)**

**Ecological Resources**

Robert Burdis	LTRM Program Water Quality Specialist	651-345-3331 x224
Mike Davis	Mississippi River Ecologist	651-345-3332 x227
Steve Delain	LTRM Program Fish Specialist	651-345-3331 x226
Beth Knudsen	Watershed Assessment Specialist	651-345-3332 x228
Megan Moore	LTRM Program Aquatic Vegetation Specialist	651-345-3331 x225
Walt Popp	LTRM Program Team Leader	651-345-3331 x223
Sarah Stegen	OAS "Administrative Asst."	651-345-3331 x221

**Fisheries**

Randy Binder	Fisheries Specialist	651-345-3365 x232
Dan Dieterman	Asst. Area Supervisor	651-345-3365 x230
Doug Dieterman	Specialist Sr/Research Biologist	651-345-3365 x236
John Hoxmeier	Research Scientist	651-345-3365 x237
Nick Schlessler	Large Lake Fisheries Specialist	651-345-3365-x235
Dan Spence	Fisheries Specialist	651-345-3365 x231
Kevin Stauffer	Area Fisheries Supervisor	651-345-3365 x229
Sarah Stegen	OAS "Administrative Asst."	651-345-3365 x221
Jeff Weiss	Fisheries Specialist	651-345-3365 x234

**Forestry**

Steve Bartz	Forester	651-345-3216 x241
Chad Gelner	Forester	651-345-3216 x239
Terry Helbig	Area Forest Supervisor	651-345-3216 x238
Larry Himanga	St Paul Staff-WildFire Prevention Coord.	651-345-3216 x243
Mike Wachholz	Program Forester	651-345-3216 x242

**Waters**

William Huber	Area Hydrologist	651-345-5601 x244
Scot Johnson	SE Groundwater Specialist	651-345-5601 x245
Sarah Stegen	OAS "Administrative Asst."	651-345-5601 x221

**Ecological Services**

Tim Schlagenhaft	Miss River & Blufflands Coordinator	651-345-3365 x233
------------------	-------------------------------------	-------------------

---

## **MPCA (Minnesota Pollution Control Agency)**

18 Woodlake Drive SE  
Rochester, MN 55904  
507-285-7343 Fax: 507-280-5513 <http://www.pca.state.mn.us>

SE MN Staff Directory: <http://www.pca.state.mn.us/index.php/about-mpca/mpca-overview/agency-structure/mpca-offices/mpca-southeast-region.html?menuid=&redirect=1>

MPCA Toll Free: 800-657-3864  
Feedlot Hotline: 877-333-3508  
MN Duty Officer: 800-422-0798

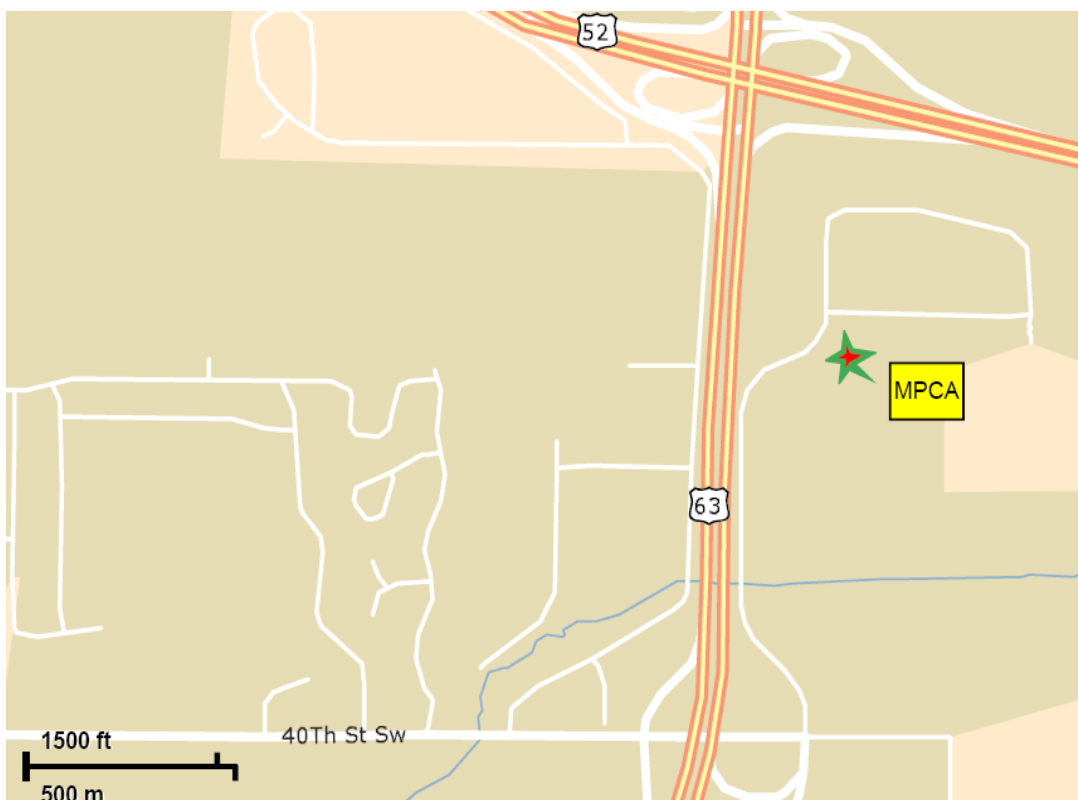

## **MPCA Southeast Region: Counties, Programs and Staff**

Welcome to the Minnesota Pollution Control Agency Southeast Region. The Southeast Region includes MPCA Offices in Mankato and Rochester. Staff Members in these offices provide environmental protection services to citizens in 20 counties.

### **Rochester Office**

18 Wood Lake Drive SE  
Rochester, MN 55904  
Phone: 507-285-7343  
Fax: 507-280-5513

### **Mankato Office**

12 Civic Center Plaza  
Suite 2165  
Mankato, MN 56001  
Phone: 507-389-5977  
Fax: 507-389-5422

**Minnesota Duty Officer: 800-422-0798**

You must call the duty officer for natural disasters, hazardous material incidents, petroleum spills, pipeline breaks or leaks, release of substances to the air, wastewater bypasses, and spills of of manure, food products, or other substances and pollutants.

## Counties Served

The MPCA's Southeast Regional Offices serve the following counties:

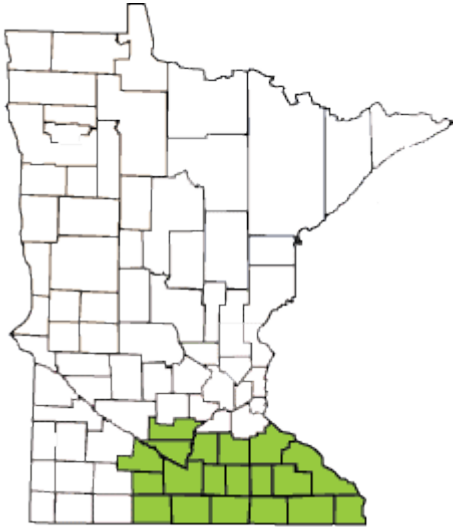

(Counties served shown in green)

- Blue Earth Brown Dodge Faribault Fillmore Freeborn Goodhue Houston
- LeSueur Martin Mower Nicollet Olmsted Rice Sibley Steele Wabasha Waseca
- Watonwan Winona

## Southeast Region Staff Directory

Staff in the Southeast Region work with the following MPCA Programs:

- [Administration](#) [Air Quality](#) [Certification/Training](#) [Emergency Response](#) [Feedlots](#)
- [Groundwater Monitoring](#) [Hazardous Waste](#) [Industrial Water Quality](#) [Petroleum Remediation](#)
- [Solid Waste](#) [Stormwater](#) [Tanks](#) [Wastewater](#) [Watersheds](#)

### ADMINISTRATION

Title	Staff Member	Phone	Location
Regional Manager	Robert Finley	507-344-5247	Mankato
Municipal Wastewater Section Manager	Wendy Turri <a href="mailto:wendy.turri@state.mn.us">wendy.turri@state.mn.us</a>	507-206-2651	Rochester
Watershed Unit Supervisor	Katherine Logan <a href="mailto:katherine.logan@state.mn.us">katherine.logan@state.mn.us</a>	507-206-2626	Rochester
Watershed Unit Supervisor	Lee Ganske <a href="mailto:lee.ganske@state.mn.us">lee.ganske@state.mn.us</a>	507-344-5248	Mankato
Wastewater Unit Supervisor	Marni Karnowski <a href="mailto:marni.karnowski@state.mn.us">marni.karnowski@state.mn.us</a>	07-206-2643	Rochester
Feedlot Unit Supervisor	David Wall <a href="mailto:david.wall@state.mn.us">david.wall@state.mn.us</a>	651-757-2806	St. Paul
Communications Specialist	Nancy Miller <a href="mailto:nancy.miller@state.mn.us">nancy.miller@state.mn.us</a>	507-206-2612	Rochester
Office Administration	Mary Linder <a href="mailto:mary.linder@state.mn.us">mary.linder@state.mn.us</a>	507-206-2624	Rochester
Office Administration	Julie Anne Johnston <a href="mailto:julianne.johnston@state.mn.us">julianne.johnston@state.mn.us</a>	507-344-5249	Mankato
Office Administration	Janine Betts <a href="mailto:janine.betts@state.mn.us">janine.betts@state.mn.us</a>	507-206-2632	Rochester
Office Administration	Jody Breuer <a href="mailto:jody.breuer@state.mn.us">jody.breuer@state.mn.us</a>	507-206-2617	Rochester
Office Administration	Cathy Eidem <a href="mailto:cathy.eidem@state.mn.us">cathy.eidem@state.mn.us</a>	507-206-2631	Rochester
Information Officer	Catherine Rofshus <a href="mailto:catherine.rofshus@state.mn.us">catherine.rofshus@state.mn.us</a>	507-206-2608	Rochester

### REGIONAL DIVISION

**Feedlot SE Unit:**

Title	Staff Member	Phone	Location
Feedlot Compliance and Enforcement/Permit Writer	Paul Brietzke <a href="mailto:paul.brietzke@state.mn.us">paul.brietzke@state.mn.us</a>	507-206-2616	Rochester
Feedlot Compliance and Enforcement	Kate Brigman <a href="mailto:kate.brigman@state.mn.us">kate.brigman@state.mn.us</a>	507-344-5241	Mankato
Feedlot Compliance and Enforcement	Wayne Cords <a href="mailto:wayne.cords@state.mn.us">wayne.cords@state.mn.us</a>	507-344-5245	Mankato
Feedlot Engineer	Joseph Cummings <a href="mailto:joseph.cummings@state.mn.us">joseph.cummings@state.mn.us</a>	507-206-2623	Rochester
Feedlot Compliance and Enforcement/Permit Write	Vacant	507-206-2631	Rochester
Feedlot Compliance and Enforcement	Steven Schmidt <a href="mailto:steven.schmidt@state.mn.us">steven.schmidt@state.mn.us</a>	507-206-2618	Rochester
Feedlot Compliance Coordinator	Lisa Scheirer <a href="mailto:lisa.scheirer@state.mn.us">lisa.scheirer@state.mn.us</a>	218-846-8122	Detroit Lakes

**Watershed SE Unit:**

Small Watershed Modeler	Khalil Ahmad <a href="mailto:khalil.ahmad@state.mn.us">khalil.ahmad@state.mn.us</a>	507-206-2613	Rochester
Watershed Student Worker	Vacant	507-344-5242	Mankato
Watershed Modeling Technician	Eileen Campbell <a href="mailto:eileen.campbell@state.mn.us">eileen.campbell@state.mn.us</a>	507-344-5244	Mankato
Watershed Project Manager	Paul A. Davis <a href="mailto:paul.a.davis@state.mn.us">paul.a.davis@state.mn.us</a>	507-344-5246	Mankato
Watershed Modeling Technician	Jennifer Ender <a href="mailto:jennifer.ender@state.mn.us">jennifer.ender@state.mn.us</a>	507-206-2620	Rochester
Watershed Project Manager	Shaina Keseley <a href="mailto:shaina.keseley@state.mn.us">shaina.keseley@state.mn.us</a>	507-206-2622	Rochester
Watershed Project Manager	Scott MacLean <a href="mailto:scott.maclean@state.mn.us">scott.maclean@state.mn.us</a>	507-344-5250	Mankato
Watershed Student Worker	Lindsey Nelson <a href="mailto:lindsey.nelson@state.mn.us">lindsey.nelson@state.mn.us</a>	507-206-2625	Rochester
Watershed GIS Specialist	Nels Rasmussen <a href="mailto:nels.rasmussen@state.mn.us">nels.rasmussen@state.mn.us</a>	507-206-2614	Rochester
Watershed Monitoring Specialist	Tiffany Schauls <a href="mailto:tiffany.schauls@state.mn.us">tiffany.schauls@state.mn.us</a>	507-206-2619	Rochester
Lower Mississippi Basin Coordinator/Lake Pepin	Norman Senjem <a href="mailto:norman.senjem@state.mn.us">norman.senjem@state.mn.us</a>	507-206-2655	Rochester
Watershed Project Manager	Bill Thompson <a href="mailto:bill.thompson@state.mn.us">bill.thompson@state.mn.us</a>	507-206-2627	Rochester
SE MN TMDL Coordinator	Justin Watkins <a href="mailto:justin.watkins@state.mn.us">justin.watkins@state.mn.us</a>	507-206-2621	Rochester
MN River Basin Hydrologist	Vacant	507-206-2631	TBD

**MUNICIPAL DIVISION****Solid Waste SE Unit:**

Solid Waste Compliance and Enforcement	Cory Boeck <a href="mailto:cory.boeck@state.mn.us">cory.boeck@state.mn.us</a>	507-206-2601	Rochester
Solid Waste Engineer	Sherri Nachtigal <a href="mailto:sherri.nachtigal@state.mn.us">sherri.nachtigal@state.mn.us</a>	507-206-2600	Rochester
Solid Waste Local Assistance	Vacant	507-206-2631	Rochester

**Stormwater Unit:**

Stormwater Compliance and Enforcement	Roberta Getman <a href="mailto:roberta.getman@state.mn.us">roberta.getman@state.mn.us</a>	507-206-2629	Rochester
---------------------------------------	---	--------------	-----------

**Wastewater SE Unit:**

Wastewater Engineer	John Carney <a href="mailto:john.carney@state.mn.us">john.carney@state.mn.us</a>	507-206-2640	Rochester
Wastewater Watershed Planning	Marco Graziani <a href="mailto:marco.graziani@state.mn.us">marco.graziani@state.mn.us</a>	651-757-2398	St. Paul
SSTS Compliance, Enforcement, Assistance	Brian Green <a href="mailto:brian.green@state.mn.us">brian.green@state.mn.us</a>	507-206-2610	Rochester
Wastewater Compliance and Enforcement	Dennis Hayes <a href="mailto:dennis.hayes@state.mn.us">dennis.hayes@state.mn.us</a>	507-206-2646	Rochester
Wastewater Compliance and Permit Writer	Nancy Heskett <a href="mailto:nancy.heskett@state.mn.us">nancy.heskett@state.mn.us</a>	507-206-2605	Rochester
Wastewater Engineer	Corey Hower <a href="mailto:corey.hower@state.mn.us">corey.hower@state.mn.us</a>	507-206-2603	Rochester
Wastewater Compliance Coordinator	Mark Hugeback <a href="mailto:mark.hugeback@state.mn.us">mark.hugeback@state.mn.us</a>	507-206-2650	Rochester
Wastewater Permit Coordinator	Deb Lindlief <a href="mailto:deb.lindlief@state.mn.us">deb.lindlief@state.mn.us</a>	218-302-6652	Duluth
Wastewater Compliance and Enforcement	Aaron Luckstein <a href="mailto:aaron.luckstein@state.mn.us">aaron.luckstein@state.mn.us</a>	507-206-2606	Rochester
Wastewater Compliance Enforcement and Permit Writer	Susan Mahowald <a href="mailto:susan.mahowald@state.mn.us">susan.mahowald@state.mn.us</a>	507-206-2604	Rochester
Wastewater Engineer	Pam Meyer <a href="mailto:pam.meyer@state.mn.us">pam.meyer@state.mn.us</a>	507-344-5251	Mankato
Wastewater Permit Writer	Melanie Miland <a href="mailto:melanie.miland@state.mn.us">melanie.miland@state.mn.us</a>	507-206-2647	Rochester
Wastewater/Landfill Hydrogeologist	Eric Porcher <a href="mailto:eric.porcher@state.mn.us">eric.porcher@state.mn.us</a>	507-206-2648	Rochester
Wastewater Compliance and Enforcement	Teresa Roth <a href="mailto:teresa.roth@state.mn.us">teresa.roth@state.mn.us</a>	507-344-5252	Mankato

**INDUSTRIAL DIVISION****Air Quality Permit Unit:**

Air Quality Permit Writer	Bruce Braaten <a href="mailto:bruce.braaten@state.mn.us">bruce.braaten@state.mn.us</a>	507-206-2607	Rochester
Air Quality Permit Writer	Marshall Cole <a href="mailto:marshall.cole@state.mn.us">marshall.cole@state.mn.us</a>	507-206-2653	Rochester

**Hazardous Waste Unit:**

Hazardous Waste/PCB Compliance and Enforcement	Joshua Burman <a href="mailto:joshua.burman@state.mn.us">joshua.burman@state.mn.us</a>	507-344-5243	Mankato
Hazardous Waste Compliance and Enforcement	Jon Gegen <a href="mailto:jon.gegen@state.mn.us">jon.gegen@state.mn.us</a>	651-757-2383	St. Paul

**Tanks Unit:**

Tanks Compliance and Enforcement	Zachary Klaus <a href="mailto:zachary.klaus@state.mn.us">zachary.klaus@state.mn.us</a>	507-206-2649	Rochester
Tanks Compliance and Enforcement	Kerry Tullis <a href="mailto:kerry.tullis@state.mn.us">kerry.tullis@state.mn.us</a>	612-559-3110	Mankato

**Water Quality Unit:**

Water Quality Permit Writer	Robert Kostinec <a href="mailto:robert.kostinec@state.mn.us">robert.kostinec@state.mn.us</a>	507-206-2628	Rochester
Water Quality Compliance and Enforcement	Ryan Swafford <a href="mailto:ryan.swafford@state.mn.us">ryan.swafford@state.mn.us</a>	507-344-5253	Mankato

**REMEDIATION DIVISION****Emergency Response:**

Emergency Response and Large Facility Cleanup	David Morrison <a href="mailto:david.morrison@state.mn.us">david.morrison@state.mn.us</a>	507-206-2644	Rochester
Emergency Response	Mike Rose <a href="mailto:mike.rose@state.mn.us">mike.rose@state.mn.us</a>	507-206-2609	Rochester

**Petroleum Remediation:**

Petroleum Remediation Specialist	Artie Dworak <a href="mailto:artie.dworak@state.mn.us">artie.dworak@state.mn.us</a>	507-206-2633	Rochester
----------------------------------	---	--------------	-----------

**ENVIRONMENTAL ANALYSIS****Ground Water and Flow:**

Ground Water/Flow Monitoring Major Watershed Coordinator	Pat Baskfield <a href="mailto:pat.baskfield@state.mn.us">pat.baskfield@state.mn.us</a>	507-344-5240	Mankato
--	--	--------------	---------

**PREVENTION/ASSISTANCE****Certification/Training Unit:**

Municipal Wastewater Trainer	David Bodovinitz <a href="mailto:david.bodovinitz@state.mn.us">david.bodovinitz@state.mn.us</a>	507-206-2654	Rochester
------------------------------	---	--------------	-----------

**Environmental Economic Development Unit:**

State Recycling Coordinator	Vacant		
-----------------------------	--------	--	--

Last modified on Tuesday, October 19, 2010 3:38 PM

**MN Department of Agriculture**

625 Robert Street North, St Paul MN 55155-2538 651-201-6000 1-800-967-2474

[www.mda.state.mn.us](http://www.mda.state.mn.us)

**MN Department of Health**

625 Robert Street North, PO Box 64975, St Paul MN 55164 651-201-4571

[www.health.state.mn.us/divs/eh/groundwater/index.html](http://www.health.state.mn.us/divs/eh/groundwater/index.html)

---